



Structure Inventory and Appraisal

Bridge ID: WESTSIDE-128681
FHWA No.: 128681

Official	SR: 79.7	SD/FO: Not Deficient or Obsolete
Unofficial	SR: 79.0	SD/FO: Not Deficient or Obsolete

IDENTIFICATION

7 Facility Carried: LOCAL
5B Rte. Signing Prefix: 4
5C Level of Service: 1 - MAINLINE
5D Inventory Route: 00000
City: RURAL
3 County: 024 - Crawford
9 Location: 084373302
5E Directional Suffix: 0 - NOT APPLICABLE
6 Feature Intersected: MILLER CREEK
2 District: 0
Garage: 000
88 Border Bridge Code:
% Responsibility: 0
99 Border Bridge No.:

INSPECTION

90 Inspection Date: 03/02/2016
Next Routine Insp Date: 03/02/2018
Inspection Agency: 5 - Consultant
93A FC Inspection Date:
92A FC Frequency: 0
93B UW Inspection Date:
92B UW Frequency: 0
93C SI Date:
92C SI Frequency: 0
Other Non-NBI Date:
Other Non-NBI Freq.:

Inspection Type: N/A
91 Frequency: 24
Next Insp Type: Regular
Inspection Group: Crawford County
Next FC Insp.: NA
Next UW Insp.: NA
Next Spec. Insp.: NA
Next Other Insp.: NA

STRUCTURE TYPE AND MATERIALS

43A Main Span: 3 - Steel
43B Main Span Design: 02 - Stringer/Multi-beam or Girder
45 No. Spans Main Unit: 1
44A Appr. Span: 000 - NA
44B Appr. Span Design: 000 - NA
46 No. of Appr. Spans: Near 0 Far 0
107 Deck Type: 8 - Wood or Timber
108A Wearing Surface: 7 - Wood or Timber
108B Membrane: 0 - None
108C Deck Protection: 0 - None

CONDITION

58 Deck: 7 - Good Condition (some minor problems)
59 Super: 7 - Good Condition (some minor problems)
60 Sub: 7 - Good Condition (some minor problems)
61 Channel/Channel Prot.: 7 - Bank protection needs minor repairs
62 Culvert: N - Not Applicable

GEOMETRIC DATA

48 Length Max Span: 50 ft.
49 Structure Length: 50 ft.
34 Skew: 0°
Deck Area: 1250.0 sq. ft.
50B Curb/Sdwb Width R: 0 ft.
50A Curb/Sdwb Width L: 0 ft.
51 Width Curb to Curb: 24.0 ft.
52 Width Out to Out: 25.0 ft.
32 Appr. Roadway width: 26 ft.
(w/ Shoulders)
33 Median: 0 - No median
35 Structure Flared: 00 - No flare
10 Vertical Clearance: 99'99"
47 Horiz. Clearance: 24'00"
53 Min. Vert. Clearance Over: 99'99"
54B Min. Vert. Underclearance: 00'00"
55 Min. Lat. Underclearance R: 00'00"
56 Min. Lat. Underclearance L: 00'00"

APPRAISAL

67 Str. Evaluation: 5 - Somewhat better than minimum adequacy
68 Deck Geometry: 6 - Equal to present minimum criteria
69 Underclear Vert & Horiz: N - Not applicable
71 Waterway Adequacy: 5 - Occasional Flooding - Significant Delays
72 Approach Alignment: 6 - Equal to present minimum criteria
36A Bridge Rail: 0 - DOES NOT MEET CURRENT SAFETY STANDARDS, OR IS NOT THERE AND IS NEEDED.
36B Transition: 0 - DOES NOT MEET CURRENT SAFETY STANDARDS, OR IS NOT THERE AND IS NEEDED
36C Approach Rail: 0 - DOES NOT MEET CURRENT SAFETY STANDARDS, OR IS NOT THERE AND IS NEEDED
36D Approach Rail Ends: 0 - DOES NOT MEET CURRENT SAFETY STANDARDS, OR IS NOT THERE AND IS NEEDED
113 Scour Critical: 8 - Stable - Excellent Condition

NAVIGATION DATA

38 Navigation Control:
0 - No navigation control on waterway (bridge permit not required)
111 Pier Protection:
39 Vertical Clearance: 00'00"
40 Horiz. Clearance: 000'00"

LOAD RATING AND POSTING

31 Design Load: 0 - Unknown
63 Rating Method: 2 - Allowable Stress (AS) reported in english tons using HS-20 loading.
64 Operating Rating: 30.8 Tons
65 Rating Method: 2 - Allowable Stress (AS) reported in english tons using HS-20 loading.
66 Inventory Rating: 20.9 Tons
70 Posting: 5 - Equal to or above legal loads
41 Posting Status: A - Open

16 Latitude: 42.04277136 17 Longitude: -95.16917294

AGE AND SERVICE

27 Year Built: 2003 Design No.: 0
106 Year Reconstructed: 0
42A Type of Service on: 1 - Highway
42B Type of Service Under: 5 - Waterway
28A Lanes on: 1 28B Lanes under: 0
29 ADT: 30 30 Year of ADT: 2012
109 Truck ADT: 0 % Speed Limit: 65
19 Detour Length: 4 mi.

FRA No. (if RR Bridge):
Mile Post:

CLASSIFICATION

112 NBIS Length: Y
28 Functional Class: 09 - Rural - Local
100 STRAHNET: 0 - Not a defense highway
101 Parallel Structure: N - No parallel structure
102 Direction of Traffic: 3 - One lane bridge for 2-way traffic
22 Owner: 02 - County Highway Agency
21 Custodian: 02 - County Highway Agency
37 Historical Significance: 3 - May be eligible for National Register
75A Type of Work Proposed:
75B Work Done by:



Structure Inventory and Appraisal

Bridge ID: WESTSIDE-128681
 FHWA No.: 128681

Official	SR: 79.7	SD/FO: Not Deficient or Obsolete
Unofficial	SR: 79.0	SD/FO: Not Deficient or Obsolete

IDENTIFICATION

7 Facility Carried: LOCAL
 5B Rte. Signing Prefix: 4
 5C Level of Service: 1 - MAINLINE
 5D Inventory Route: 00000
 City: RURAL
 3 County: 024 - Crawford
 9 Location: 084373302
 5E Directional Suffix: 0 - NOT APPLICABLE
 6 Feature Intersected: MILLER CREEK
 2 District: 0
 Garage: 000
 98 Border Bridge Code:
 % Responsibility: 0
 99 Border Bridge No.:

INSPECTION

90 Inspection Date: 03/31/2014
 Next Routine Insp Date: 03/31/2016
 Inspection Agency: 5 - Consultant
 93A FC Inspection Date:
 92A FC Frequency: 0
 93B UW Inspection Date:
 92B UW Frequency: 0
 93C SI Date:
 92C SI Frequency: 0
 Other Non-NBI Date:
 Other Non-NBI Freq.:

Inspection Type: N/A
 91 Frequency: 24
 Next Insp Type: Regular
 Inspection Group: Crawford County
 Next FC Insp.: NA
 Next UW Insp.: NA
 Next Spec. Insp.: NA
 Next Other Insp.: NA

STRUCTURE TYPE AND MATERIALS

43A Main Span 3 - Steel
 43B Main Span Design: 02 - Stringer/Multi-beam or Girder
 45 No. Spans Main Unit: 1
 44A Appr. Span 000 - NA
 44B Appr. Span Design: 000 - NA
 46 No. of Appr. Spans: Near 0 Far 0
 107 Deck Type: 8 - Wood or Timber
 108A Wearing Surface: 7 - Wood or Timber
 108B Membrane: 0 - None
 108C Deck Protection: 0 - None

CONDITION

58 Deck: 8 - Very Good Condition (no problems noted)
 59 Super: 7 - Good Condition (some minor problems)
 60 Sub: 7 - Good Condition (some minor problems)
 61 Channel/Channel Prot.: 7 - Bank protection needs minor repairs
 62 Culvert: N - Not Applicable

GEOMETRIC DATA

48 Length Max Span: 50 ft.
 49 Structure Length: 50 ft.
 34 Skew: 0°
 Deck Area: 1250.0 sq. ft.
 50B Curb/Sdwk Width R: 0 ft.
 50A Curb/Sdwk Width L: 0 ft.
 51 Width Curb to Curb: 24.0 ft.
 52 Width Out to Out: 25.0 ft.
 32 Appr. Roadway width: 26 ft.
 (w/ Shoulders)
 33 Median: 0 - No median
 35 Structure Flared: 00 - No flare
 10 Vertical Clearance: 99'99"
 47 Horiz. Clearance: 24'00"
 53 Min. Vert. Clearance Over: 99'99"
 54B Min. Vert. Underclearance: 00'00"
 55 Min. Lat. Underclearance R: 00'00"
 56 Min. Lat. Underclearance L: 00'00"

APPRAISAL

67 Str. Evaluation: 5 - Somewhat better than minimum adequacy
 68 Deck Geometry: 6 - Equal to present minimum criteria
 69 Underclear Vert & Horiz: N - Not applicable
 71 Waterway Adequacy: 5 - Occasional Flooding - Significant Delays
 72 Approach Alignment: 6 - Equal to present minimum criteria
 36A Bridge Rail: 0 - DOES NOT MEET CURRENT SAFETY STANDARDS, OR IS NOT THERE AND IS NEEDED.
 36B Transition: 0 - DOES NOT MEET CURRENT SAFETY STANDARDS, OR IS NOT THERE AND IS NEEDED
 36C Approach Rail: 0 - DOES NOT MEET CURRENT SAFETY STANDARDS, OR IS NOT THERE AND IS NEEDED
 36D Approach Rail Ends: 0 - DOES NOT MEET CURRENT SAFETY STANDARDS, OR IS NOT THERE AND IS NEEDED
 113 Scour Critical: 8 - Stable - Excellent Condition

NAVIGATION DATA

38 Navigation Control:
 0 - No navigation control on waterway (bridge permit not required)
 111 Pier Protection:
 39 Vertical Clearance: 00'00"
 40 Horiz. Clearance: 000'00"

LOAD RATING AND POSTING

31 Design Load: 0 - Unknown
 63 Rating Method: 2 - Allowable Stress (AS) reported in english tons using HS-20 loading.
 64 Operating Rating: 30.8 Tons
 65 Rating Method: 2 - Allowable Stress (AS) reported in english tons using HS-20 loading.
 66 Inventory Rating: 20.9 Tons
 70 Posting: 5 - Equal to or above legal loads
 41 Posting Status: A - Open

16 Latitude: 42.04277136 17 Longitude: -95.16917294

AGE AND SERVICE

27 Year Built: 2003 Design No.: 0
 106 Year Reconstructed: 0
 42A Type of Service on: 1 - Highway
 42B Type of Service Under: 5 - Waterway
 28A Lanes on: 1 28B Lanes under: 0
 29 ADT: 30 30 Year of ADT: 2012
 109 Truck ADT: 0 % Speed Limit: 55
 19 Detour Length: 4 mi.

FRA No. (if RR Bridge):
 Mile Post:

CLASSIFICATION

112 NBIS Length: Y
 26 Functional Class: 09 - Rural - Local
 100 STRAHNET: 0 - Not a defense highway
 101 Parallel Structure: N - No parallel structure
 102 Direction of Traffic: 3 - One lane bridge for 2-way traffic
 22 Owner: 02 - County Highway Agency
 21 Custodian: 02 - County Highway Agency
 37 Historical Significance: 3 - May be eligible for National Register
 75A Type of Work Proposed:
 75B Work Done by:

Crawford County Day Labor Bridge Construction

Prepared By: Ross Wood / Terry Lally Date: _____

Township: Westside Section: _____ E911 Rd.: _____

FHWA No.: 128681 Date Reconstructed: 2003

Describe Work: Replace old bridge with I-beam bridge

Bridge Length: 50' <u>50'</u>	Bridge Width: <u>29'</u>	Open Depth: _____				
Beam Info.	Deck Info.	Diaphragm Info.				
Beam Type: <u>(W) S</u>	Deck Type: <u>Wood</u>	# Bolts per Angle: <u>3</u>				
Beam Spacing: <u>38 1/2" C-C</u>	Top: <u>3x12</u> Longitudinal	Bolt Size: <u>7/8"</u>				
Beam Depth: <u>24"</u>	Bottom: <u>4x16</u> Transverse	Diaphragm Length: <u>24"</u>				
Flange: <table style="display: inline-table; border: none;"><tr><td style="border: none; padding-right: 5px;">Width</td><td style="border: none; padding-right: 5px;">Thickness</td></tr><tr><td style="border: none; text-align: center;">9"</td><td style="border: none; text-align: center;">3/4"</td></tr></table>	Width	Thickness	9"	3/4"	Spacing on Bottom: <u>28" C-C</u>	Diaphragm Size: _____
Width	Thickness					
9"	3/4"					
Web Thickness: <u>1/2"</u>						

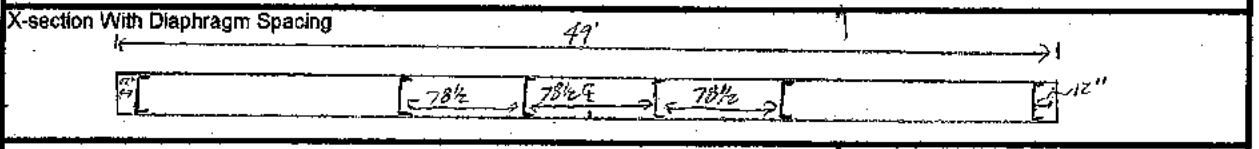
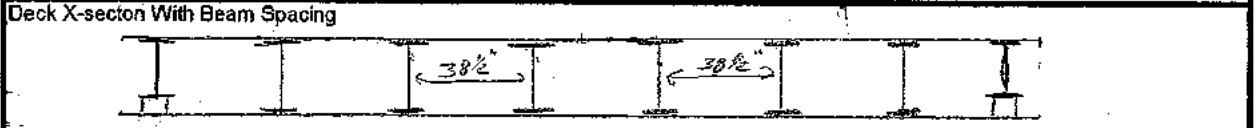

Substructure Comments: _____

Comments: Outside Z I-beams are to be 21" I-beams

west side

Client: #5 128680

Site: _____

Project No: _____

Date: _____

Initials: _____

BARKER, LEMAR & ASSOCIATES, INC.
 1300 Cummins Road - Suite 201
 Des Moines, Iowa 50315
 Phone: 515-256-8814
 Fax: 515-256-0152

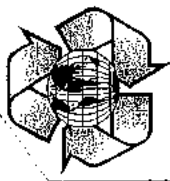

Using 21" I beams on outside of bridges.
 The rest of the beams to be 24"

I beams set @ 38 1/2" Spacing C-C

I beams for
 BOTH 49' bridges

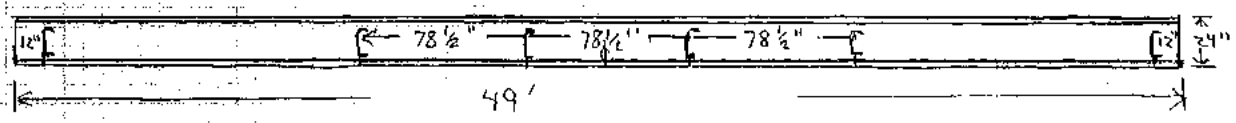
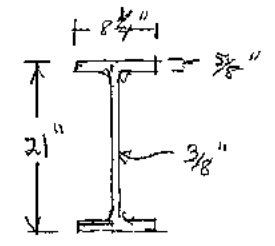
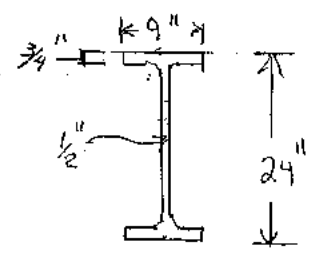

Project Number: LB47-33W		CRAWFORD COUNTY DAY LABOR PROJECT SHEET																				Date: July 30 03												
Location: 180503w										Section:										Township: Westside 32 & 33														
Description of Work:		Replace old bridge with new 24" I beam bridge with 4 wings.																				FHWA No:												
For the month of:																						Bridge Type:												
May & June																																		
Employee	Hours worked per day																															Total Hours	Hourly Rate	Totals
	1	2	3	4	5	6	7	8	9	10	11	12	13	14	15	16	17	18	19	20	21	22	23	24	25	26	27	28	29	30	31			
Terry Lally				8	8				8		4					8	8	8	8	8								4	8	8	8	96	\$ 34.60	\$3,321.60
Dan Blunk				8	8				8		8	8				8	8	8	8	8								4	8	8	8	108	\$ 31.49	\$3,400.92
Howard Clark				8	8				8		8	8				8	8	8									8	8	8	8	96	\$ 25.11	\$2,410.56	
Corey Curnyn				8	8				8		8	8				8	8	8	8	8							8	8	8		104	\$ 25.03	\$2,603.12	
Kyle Schultz				8	8				8		8	8				8	8	8	8	8							8	8	8	8	112	\$ 21.50	\$2,408.00	
Chris Boeck				8	8				8		8	8				8	8	8	8	8							8	8	8	8	112	\$ 9.63	\$1,078.56	
																															0	\$ -	\$0.00	
																															0	\$ -	\$0.00	
																															0	\$ -	\$0.00	
																															0	\$ -	\$0.00	
																															0	\$ -	\$0.00	
																						Labor Cost:		\$15,222.76										
Equipment	Hours worked per day																															Total Hours	Hourly Rate	Totals
	1	2	3	4	5	6	7	8	9	10	11	12	13	14	15	16	17	18	19	20	21	22	23	24	25	26	27	28	29	30	31			
#83 Cat Excavater				5	5				6		7	6				6	7	6	6	6							3	5	6	5	79	\$ 72.99	\$5,766.21	
#73 Koering Crane				6	6				3		4					4	2										3	3		3	34	\$ 97.52	\$3,315.68	
#103 Tele-Crane																															0	\$ 89.90	\$0.00	
#75 IHT> Dozer										3	4					4	4		6							3	2	2		28	\$ 39.84	\$1,115.52		
#59 J. D. Dozer					1						3					2	2	4		4									1		17	\$ 25.17	\$427.89	
#32 J.D. crawler										1	3							4		4						2		2		16	\$ 26.95	\$431.20		
#87 Air Comp.																			1											1	\$ -	\$0.00		
#63 Welder					3																									3	\$ -	\$0.00		
#18 Tool Truck				2	2				2		2	2				2	2	2	2	2							2	2	2	2	28	\$ 9.26	\$259.28	
																															0	\$ -	\$0.00	
																															0	\$ -	\$0.00	
																															0	\$ -	\$0.00	
																						Equipment Costs:		\$11,315.78										
No. of pieces	Size	Materials List		Stockpile location or purchased from	New/Used	No. Units	* Units	Unit Cost	Total Costs																									
65		plank clips			New/	65	each	\$ 0.95	\$ 61.75	Total Labor Costs: \$15,222.76																								
6	50'	24" I beams		stock	used	6	each	\$ 470.00	\$ 2,820.00	Materials (page 1): \$ 3,701.75																								
2	50'	24" I beams		stock	used	2	each	\$ 410.00	\$ 820.00	Materials (page 2): \$ 15,192.75																								
						0		\$ -	\$ -	Total Material Cost: \$18,894.50																								
						0		\$ -	\$ -	Equipment Costs: \$11,315.78																								
						0		\$ -	\$ -	Total Costs: \$45,433.04																								
						0		\$ -	\$ -	Material Costs (page 1): \$ 3,701.75																								

Crawford County Secondary Roads Material List					Project No.:			
No. Pieces	Size	Description of Materials Used:	Stockpile Location or Direct Purchase From	New or Used	No. Units	Units *(see below)	Unit Cost	Total Cost
101	3"x12"	16' Plank	Denison	used	1616	In.ft.	\$ 1.25	\$2,020.00
	3"x12"	18' Plank	Denison	new	0	In.ft.	\$ 2.51	\$0.00
60	3"x12"	20' Plank	Denison	new	1200	In.ft.	\$ 2.51	\$3,012.00
	3"x12"	22' Plank	Denison	new	0	In.ft.	\$ 2.58	\$0.00
22	3"x12"	24' plank	Denison	new	528	In.ft.	\$ 1.25	\$660.00
	4"x12"	16' plank			0	In.ft.	\$ -	\$0.00
	4"x12"	24' plank			0	In.ft.	\$ 3.99	\$0.00
22	4"x16"	any length			528	In.ft.	\$ 2.50	\$1,320.00
					0		\$ -	\$0.00
	10"x10"	Wood Cap			0	In.ft.	\$ 9.17	\$0.00
	12"x12"	Wood Cap			0	In.ft.	\$ 13.20	\$0.00
					0		\$ -	\$0.00
	4"x6"	12' nailer			0	each	\$ 26.05	\$0.00
	4"x6"	16' nailer			0	each	\$ 29.77	\$0.00
					0		\$ -	\$0.00
	2"x4"	any length			0	In.ft.	\$ 0.28	\$0.00
	2"x6"	any length				In.ft.	\$ 0.39	\$0.00
	1/2"	4'x8' plywood			0	each	\$ 11.05	\$0.00
	3/4"	4'x8' plywood			0	each	\$ -	\$0.00
					0		\$ -	\$0.00
	25'	wood piling			0	each	\$ 141.36	\$0.00
8	30'	wood piling			0	each	\$ 168.00	\$0.00
	35'	wood piling			0	each	\$ 217.69	\$0.00
	40'	wood piling			0	each	\$ 296.37	\$0.00
					0		\$ -	\$0.00
	8"x8"	40'steel@36lb./ft.			0	In. ft.	\$ 7.41	\$0.00
	8"x8"	50'steel @36lb./ft			0	In. ft.	\$ -	\$0.00
Total Materials (page two) :								\$7,012.00