

COPY

INDEXED DM/DM
FOLLOW UP g
PROOFED g
SCANNED g



Crawford County Recorder Denise Meeves
Fee Book 2007-0369 REC013431
02/08/2007 @1053AM # Pages 1
PLC PLAT CORNER CER
Total Fees: \$7.00

PREPARED BY & RETURN TO MIKE SCHULTE, SNYDER & ASSOCIATES, INC. 1800 WEST 22nd St, ATLANTIC, IA 50022 (712) 249-6505

UNITED STATES PUBLIC LAND SURVEY CORNER CERTIFICATE OF

Land Survey Monuments situated in Section 13, Township 84 N, Range 37 W, of the Fifth Principal Meridian, CRAWFORD County, Iowa. Previously recorded in N/A in County Recorder's Office.
(book, page, document number, ect.)

(Show reason for preparing this certificate, the evidence and detailed procedures used in establishing the corner positions and monumentation found or placed.)

Monument Description and Remarks:

SE CORNER OF THE SOUTHWEST QUARTER OF THE SOUTHWEST QUARTER
FOUND 3"x2" 1/2" ANGLE IRON, 12" DEEP. SET 1/2" REBAR W/CAP # 17979 ABOVE

NOTE: CORNER IS LOCATED IN A FARM FIELD NEAR AND OLD BROKEN FENCE. THE FENCE IS IN SUCH POOR CONDITION THAT IT WAS NOT USED FOR THE TYPICAL TIE POINTS. DUE TO THE POSSIBILITY OF EXCAVATION IN THE AREA IN THE FUTURE, ADDITIONAL REBAR SURROUNDING THE CORNER WERE NOT SET EITHER. RATHER, PROPERTY CORNERS SET FOR THE BOUNDARY OF THE PARCEL WERE USED AS REFERENCE POINTS.

Plan-View

(Show a minimum of three reference ties to durable physical objects, relevant monuments and physical conditions that will enable recovery of the corner.)

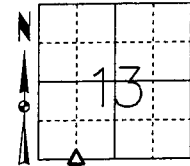

SE COR OF THE SW1/4 OF THE SW1/4
FND 3"x2"x1/2" ANGLE IRON/SET 1/2" REBAR WITH CAP #17979 OVER

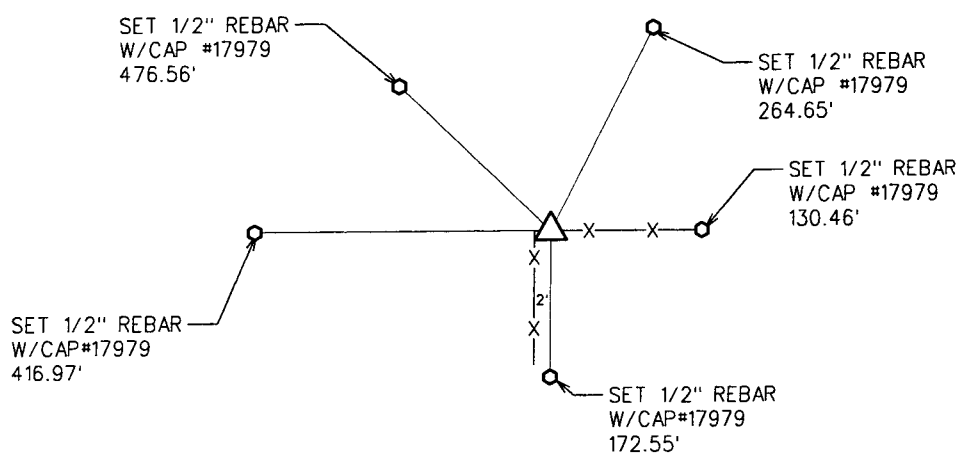

SPC-IA NORTH
US SURVEY FT (NAD83-1996)
N: 766846.98
E: 1205788.85

NOTE: ALL DISTANCES MEASURED HORIZONTAL



I hereby certify that this land surveying document was prepared and the related surveying work was performed by me or under my direct supervision and that I am a duly licensed Land Surveyor under the laws of the State of Iowa.

Mike Schulte 2/05/07
Mike Schulte, PLS Date

License Number 17979
My License Renewal Date is December 31, 2007

Pages or sheets covered by this seal:
SHEET 1 OF 1

List Corners to be Indexed

Corners	Section	Twp	Range
S1/4 Corner-SW1/4	13	84	37

TECH: KJH PN: N1/4_84-37-13 107.0032 DATE: 2-05-07