

Sara Meseck, RECORDER  
 Crawford County, Iowa  
 Instr. Number: 2023-0578  
 Recorded: 3/31/2023 at 9:34:30.0 AM  
 Pages 1  
 County Recording Fee: \$7.00  
 Iowa E-Filing Fee: \$3.13  
 Combined Fee: \$10.13  
 Revenue Tax:

PREPARED BY AND RETURN TO: MIKE SCHULTE, SCHULTE SURVEYING, INC., 2003 390TH STREET, WESTSIDE, IA 51467 (712) 790-3489

**UNITED STATES PUBLIC LAND SURVEY CORNER CERTIFICATE OF**  
 LAND SURVEY MONUMENTS SITUATED IN SECTION 24, TOWNSHIP 84 NORTH, RANGE 37 WEST, OF THE FIFTH  
 PRINCIPAL MERIDIAN, CRAWFORD COUNTY, IOWA. PREVIOUSLY RECORDED IN SEE BELOW IN COUNTY  
(book, page instrument number)  
 RECORDER'S OFFICE.

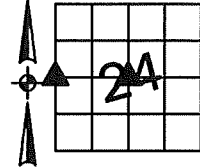

**W1/4 CORNER**  
**FND CONCRETE MONUMENT**

N=7264544.95 E=16668981.43 Z=1350.37  
 USED CERTIFICATE RECORDED IN INSTRUMENT #96-1483 TO FIND A  
 CONCRETE MONUMENT 4" DEEP IN WASHOUT. VERIFIED WITH 4  
 REMAINING TIES.  
 THIS CERTIFICATE IS BEING FILED TO UPDATE THE REFERENCE TIES.

**CENTER OF SECTION**  
**FND IRON PIN CAP #5796**

N=7264556.24 E=16671586.20 Z=1362.62  
 USED CERTIFICATE RECORDED IN INSTRUMENT #96-1483 TO FIND  
 AN IRON PIPE CAP #5796. VERIFIED WITH 3 REMAINING TIES.  
 THIS CERTIFICATE IS BEING FILED TO UPDATE THE REFERENCE TIES.

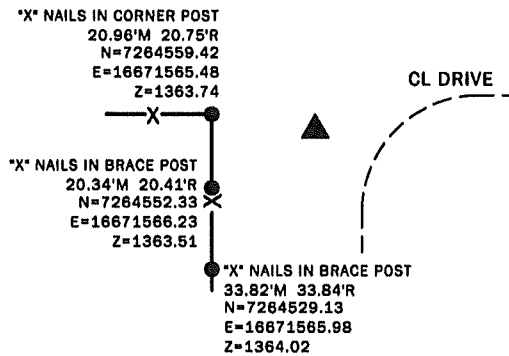
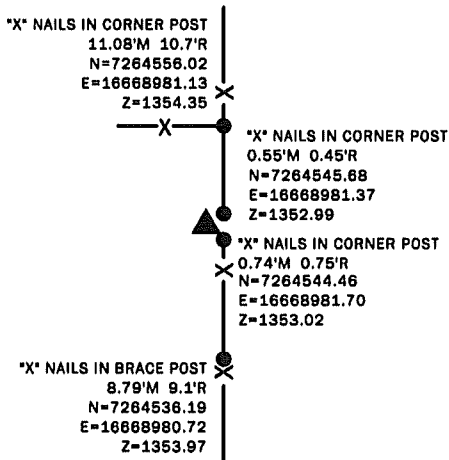

\*All distances are measured horizontally unless noted.

I HEREBY CERTIFY THAT THIS LAND SURVEYING DOCUMENT WAS  
 PREPARED BY ME OR UNDER MY DIRECT PERSONAL SUPERVISION AND  
 THAT I AM A DULY LICENSED PROFESSIONAL LAND SURVEYOR UNDER  
 THE LAWS OF THE STATE OF IOWA.

*Mike Schulte*  
 MIKE SCHULTE  
 LICENSE NUMBER: 17979  
 LICENSE RENEWAL DATE IS DECEMBER 31, 2023  
 PAGES COVERED BY THIS SEAL: 1 OF 1

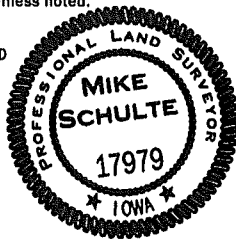

**LIST CORNERS TO BE INDEXED**

CORNER	SECTION	TWP	RANGE
CENTER OF SECTION	24	84	37
W1/4 CORNER	24	84	37
E1/4 CORNER	23	84	37

**BASIS OF BEARING**

16RCS ZONE 8 - US SURVEY FEET  
 16RTN DERIVED - NAD83(2011)(EPOCH 2010.00)