

Denise Meeves RECORDER
 Crawford County, Iowa
 Instr. Number: 2022-1327
 Recorded: 5/19/2022 at 9:17:49.0 AM
 Pages 1
 County Recording Fee: \$7.00
 Iowa E-Filing Fee: \$3.13
 Combined Fee: \$10.13
 Revenue Tax:

PREPARED BY AND RETURN TO: MIKE SCHULTE, SCHULTE SURVEYING, INC., 2003 390TH STREET, WESTSIDE, IA 51467 (712) 790-3489

UNITED STATES PUBLIC LAND SURVEY CORNER CERTIFICATE OF
 LAND SURVEY MONUMENTS SITUATED IN SECTION 27, TOWNSHIP 82 NORTH, RANGE 39 WEST, OF THE FIFTH
 PRINCIPAL MERIDIAN, CRAWFORD COUNTY, IOWA. PREVIOUSLY RECORDED IN SEE BELOW IN COUNTY
(book, page instrument number)
 RECORDER'S OFFICE.

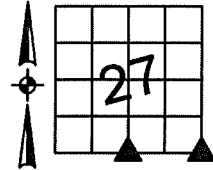

SOUTH 1/4 CORNER

FND 5/8" REBAR OPC #14709 4" DEEP
 N=7193447.71 E=16598095.95 Z=1415.97
 USED A METAL DETECTOR TO FIND A 5/8" REBAR OPC #14709 4" DEEP.
 VERIFIED WITH SURROUNDING FIELD EVIDENCE AND ACCEPTED AS
 SECTION CORNER.
 THIS CERTIFICATE IS BEING FILED BECAUSE THERE IS NONE OF RECORD.

SOUTHEAST CORNER

FND 1/2" REBAR YPC #6711 2" DEEP
 N=7193501.89 E=16600707.62 Z=1324.26
 USED A METAL DETECTOR TO FIND A 1/2" REBAR YPC #6711 2" DEEP.
 VERIFIED WITH DISTANCES SHOWN ON AN UNRECORDED PLAT OF
 SURVEY AND SURROUNDING FIELD EVIDENCE; ACCEPTED AS SECTION
 CORNER.
 THIS CERTIFICATE IS BEING FILED BECAUSE THERE IS NONE OF RECORD.

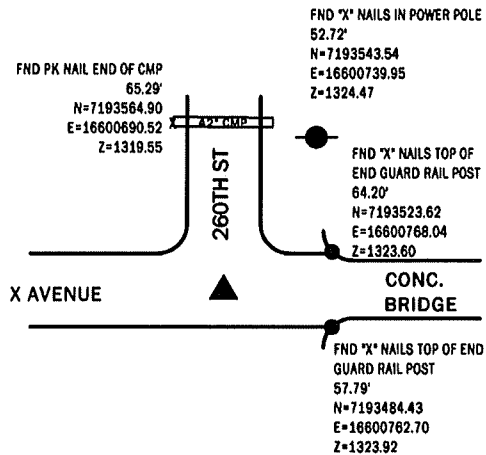
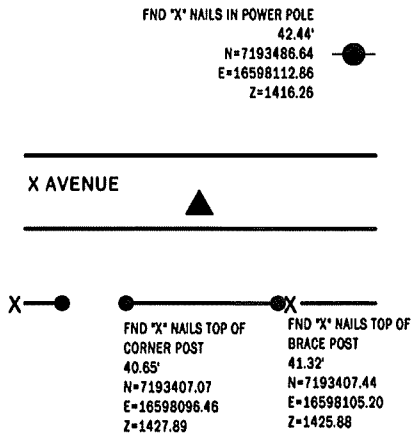

*All distances are measured horizontally unless noted.

I HEREBY CERTIFY THAT THIS LAND SURVEYING DOCUMENT WAS
 PREPARED BY ME OR UNDER MY DIRECT PERSONAL SUPERVISION AND
 THAT I AM A DULY LICENSED PROFESSIONAL LAND SURVEYOR UNDER
 THE LAWS OF THE STATE OF IOWA.

Mike Schulte
 MIKE SCHULTE
 LICENSE NUMBER: 17979
 LICENSE RENEWAL DATE IS DECEMBER 31, 2023
 PAGES COVERED BY THIS SEAL: 1 OF 1

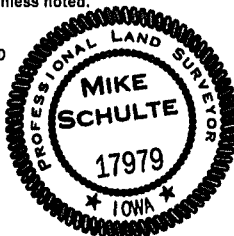

LIST CORNERS TO BE INDEXED

CORNER	SECTION	TWP	RANGE
S1/4 CORNER	27	82	39
N1/4 CORNER	34	82	39
SE CORNER	27	82	39
SW CORNER	26	82	39
NW CORNER	35	82	39
NE CORNER	34	82	39

BASIS OF BEARING

16RCS ZONE 6 - US SURVEY FEET
 16RTN DERIVED - NAD83(2011)EPOCH 2010.00

SCHULTE SURVEYING, INC.

DRAWN BY: MLS
 PROJ NUMBER: 22-025