

Sara Meseck, RECORDER
 Crawford County, Iowa
 Instr. Number: 2023-2114
 Recorded: 11/29/2023 at 12:36:40.0 PM
 Pages 1
 County Recording Fee: \$7.00
 Iowa E-Filing Fee: \$3.13
 Combined Fee: \$10.13
 Revenue Tax:

PREPARED BY AND RETURN TO: MIKE SCHULTE, SCHULTE SURVEYING, INC., 2003 390TH STREET, WESTSIDE, IA 51467 (712) 790-3489

UNITED STATES PUBLIC LAND SURVEY CORNER CERTIFICATE OF
 LAND SURVEY MONUMENTS SITUATED IN SECTION 14, TOWNSHIP 82 NORTH, RANGE 39 WEST, OF THE FIFTH
 PRINCIPAL MERIDIAN, CRAWFORD COUNTY, IOWA. PREVIOUSLY RECORDED IN SEE BELOW IN COUNTY
 RECORDER'S OFFICE. (book, page instrument number)

SW CORNER

SET 5/8" REBAR YPC #17979 10" DEEP

N=7204069.40 E=16600636.22

USED CERTIFICATE RECORDED IN INSTRUMENT #2000-2177. COULD NOT FIND CONCRETE MONUMENT.
 ROAD MAY HAVE BEEN LOWERED. USED RECORDED TIES AND PLAT RECORDED IN INSTRUMENT
 #2000-2175 TO RE-SET MONUMENT WITH A 5/8" REBAR YPC #17979 10" DEEP.
 THIS CERTIFICATE IS BEING FILED DUE TO SETTING A NEW MONUMENT.

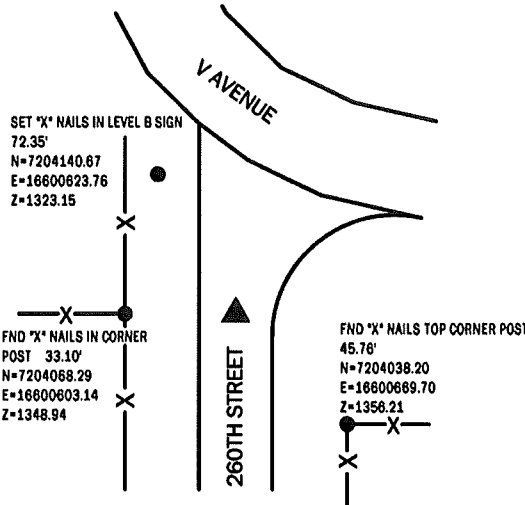
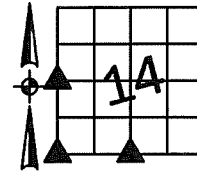

S1/4 CORNER

FND CONCRETE MONUMENT W/ 1/2" REBAR 7" DEEP

N=7204160.29 E=16603281.87 Z=1438.77

USED CERTIFICATE RECORDED IN INSTRUMENT #2000-2177 TO FIND A
 CONCRETE MONUMENT WITH A 1/2" REBAR 7" DEEP. VERIFIED WITH 2
 REMAINING TIES AND ACCEPTED.
 THIS CERTIFICATE IS BEING FILED TO UPDATE THE REFERENCE TIES.

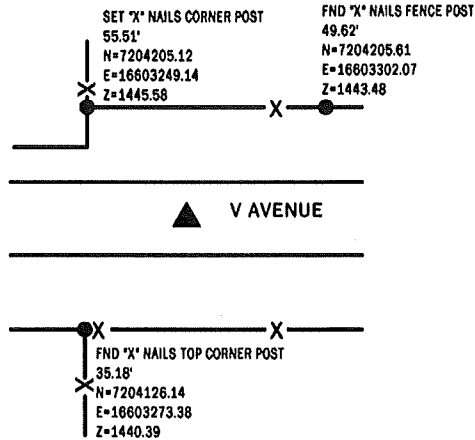

W1/4 CORNER

SET 5/8" REBAR YPC #17979 4" DEEP

N=7206716.39 E=16600628.55 Z=1287.69

NO RECORD OF CORNER EXISTS. EXAMINED LOCATION OF THE SPLIT OF THE
 NW AND SW CORNER AND FENCE WEST. ALSO EXAMINED THE ORIGINAL GLO
 NOTES WHERE THEY REFERENCED THE CREEK AND THE CORNER LANDED
 NORTH OF THE CROSSING. ACCEPTED WEST FENCE AS EVIDENCE OF THE
 ORIGINAL LINE AND USED THE BOX CULVERT IN ROAD FOR LINE. SET 5/8"
 REBAR YPC 17979 4" DEEP.
 THIS CERTIFICATE IS BEING FILED SINCE THERE ARE NO TIES OF RECORD.

*All distances are measured horizontally unless noted.

I HEREBY CERTIFY THAT THIS LAND SURVEYING DOCUMENT WAS
 PREPARED BY ME OR UNDER MY DIRECT PERSONAL SUPERVISION AND
 THAT I AM A DULY LICENSED PROFESSIONAL LAND SURVEYOR UNDER
 THE LAWS OF THE STATE OF IOWA.

Mike Schulte
 MIKE SCHULTE
 LICENSE NUMBER: 17979
 LICENSE RENEWAL DATE IS DECEMBER 31, 2023
 PAGES COVERED BY THIS SEAL: 1 OF 1



LIST CORNERS TO BE INDEXED

CORNER	SECTION	TWP	RANGE
W1/4 CORNER	14	82	39
E1/4 CORNER	15	82	39
SW CORNER	14	82	39
SE CORNER	15	82	39
NE CORNER	22	82	39
NW CORNER	23	82	39
S1/4 CORNER	14	82	39
N1/4 CORNER	23	82	39

BASIS OF BEARING

1sRCS ZONE 6 - US SURVEY FEET
 1sRTN DERIVED - NAD83(2011)(EPOCH 2010.00)

SCHULTE SURVEYING, INC.

DRAWN BY: MLS/SLG
 PROJ NUMBER: 23-094