

2000 AU 23 PH 1:04
INST. NO. 2000-2176

INDEXED *ME*
FOLLOW UP *ME*
APPROVED *ME*

DENISE MEEVES, RECORDER
Denise Meeves
FEE #6.00
Manly City, Deputy
PHONE (712)263-8118

PREPARED BY - TERENCE E. CRAWFORD - SUNDQUIST ENGINEERING - 120 S. MAIN, DENISON, IOWA 51442

UNITED STATES PUBLIC LAND SURVEY CORNER CERTIFICATE OF

LAND SURVEY MONUMENT SITUATED IN SECTION 16, T 82 N, R 39 W OF
THE 5TH P.M., CRAWFORD COUNTY, IOWA.
PREVIOUSLY RECORDED IN BOOK _____, PAGE _____, OTHER _____

MONUMENT DESCRIPTION AND REMARKS

E1/4 CORNER - FOUND 1" DIA. PIN 8" DEEP IN AREA ACCORDING
TO OLD COUNTY INFORMATION
SE CORNER - FOUND CM 8" DEEP WITH PIECES OF BRICK OVER TOP

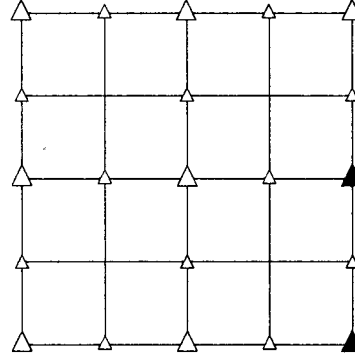

PLAN VIEW SHOWING RELATIVE LOCATION OF MONUMENT AND REFERENCE POINTS.

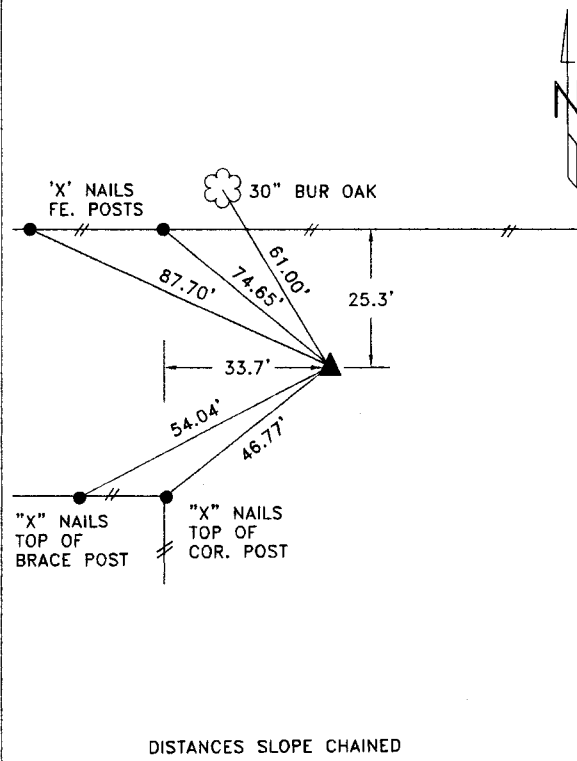
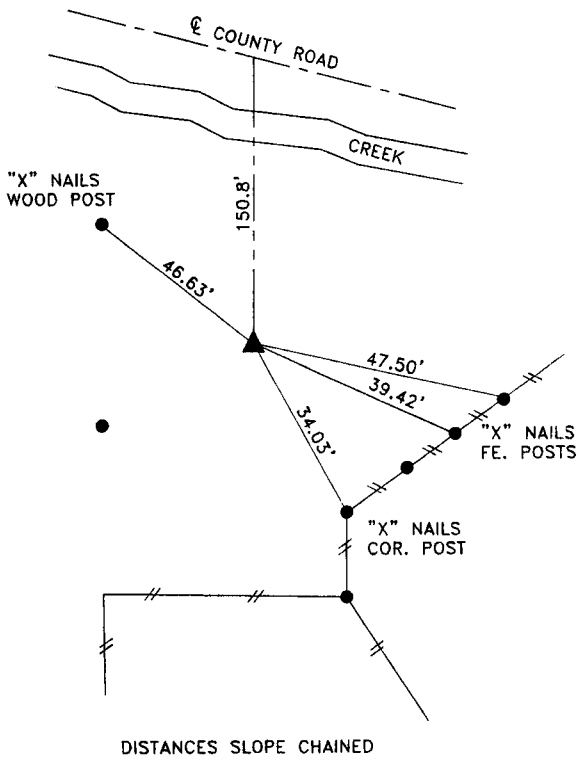

E1/4 CORNER SECTION 16-82-39

SE CORNER SECTION 16-82-39

I HEREBY CERTIFY THAT THIS LAND SURVEYING DOCUMENT WAS PREPARED
AND THE RELATED SURVEY WORK WAS PERFORMED BY ME OR UNDER
MY DIRECT SUPERVISION AND THAT I AM A DULY LICENSED LAND
SURVEYOR UNDER THE LAWS OF THE STATE OF IOWA.

Terence E. Crawford AUG 03 2000
TERENCE E. CRAWFORD DATE

IA LICENSE NO. 8893 EXP. DATE DECEMBER 31, 2001

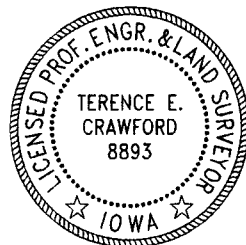

SE PROJECT NO. 23800