

2021 E 1/4 Cor Sec 20

4-22-41 At location indicated by Co. BK #10

Page 41 dug 7' x 6' x 8' hole (7 deep)

Found 7 pieces of brick, 4 small pieces of sandstone, 2 latk 1/4 x 2 x 10" and iron stake 3/4" round x 16' long & rotted walnut stake 7 (Seven) ft below road surface.

lowered all evidence & set C.M. marked 20 | 21

127.6 W from x-spikes in Black Cherry (largest of ch)

32.9 W from x-spikes in 8" oak cor. post

162.3 SW from x-spikes in 10" Black cherry

32.9 E from x-spikes in new 7" oak brace post

31.5 E from x-spikes 8' old brace post

17 N 1/4 cor Sec. 20

20 4-22-40 At location indicated

by range of fences E.W. & N.S.

dug 1/2 x 10 x 10' hole. Cor. May fall in creek.

Cor. Ties

4-22-41

Partly Cloudy 59°F Proj. E.W. Hughes
Windy 59°F Seachia 10/29/95
Dodge

FOUND ON TOP SURFACE BRICKS OF 6" & 8" PERIOD BEGINS AT APPROX

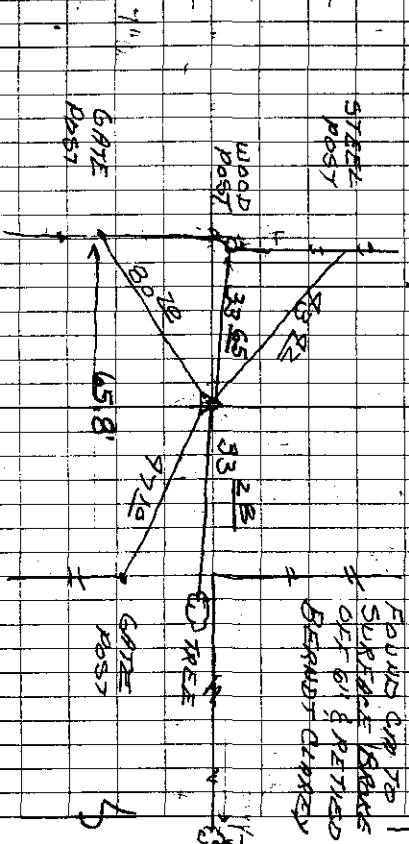

Partly Cloudy 4-22-40 Aerial Photo E.W. Hughes
Sought + 4-22-44
Bendixsen King