

2021 E 1/4 Cor Sec 20

4-22-41 At location indicated by Co. BK #10

page 41 dug 7' x 6' x 8' hole (7' deep).

Found 7 pieces of brick, 4 small pieces of sandstone, 2 lath 1/4" x 2" x 10", and iron stake 3/4" round x 16" long & rotted walnut stake 7 (Seven) ft below road surface.

lowered all evidence 4 1/2 ft C.M. marked 20 | 21

127.6 W from x-spikes in Black Cherry (largest of dim)

32.9 W from x-spikes in 8" oak cor. post

162.3 SW from x-spikes in 10" Black cherry

32.9 E from x-spikes in new 7" oak brace post

31.5 E from x-spikes 8' old brace post

17 N 1/4 cor. Sec. 20

20 4-22-40 At location indicated

bp range of fences E W & N S.

dug 1/2 x 10 x 10' hole. Cor. May fall in creek.

Cor. Ties

4-22-41

Partly Cloudy
Windy
59°F
Prof. Eng'l Hughes
Sachsa
Placer
10/23/95

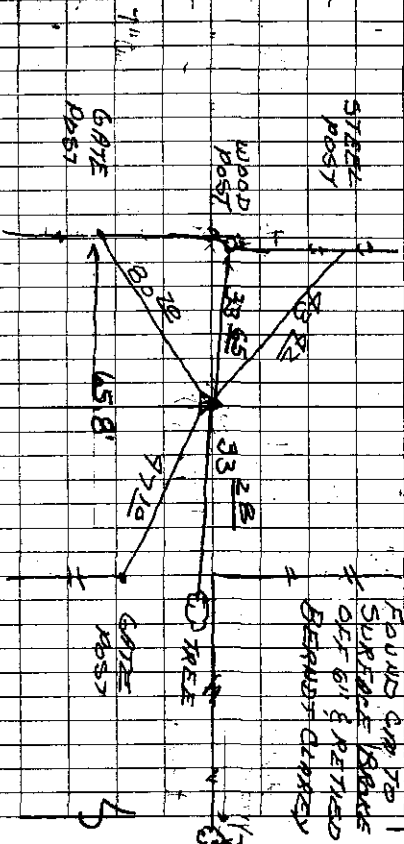

Partly Cloudy 4-22-40
Sought 4-22-40
Prof. Eng'l Hughes
Bendixen King