

89 Found gas pipe 1/2" x 3' long
 1 above ground water table
 side of pipe large amt. of brick bats
 bedrock 2' x 6" x 8" 14" deep. Lowered
 and set C.M. Set gas pipe at side of C.M.
 1 above ground as found.
 ties from 48" in cor post.
 56 S S. from 48" C.M. tie
 12.1 N. " " 1st post S.
 1.1 N. " " cor post.

5 5-12-40. Dig - 6" x 2' x 10' hole
 8 1/2" line of E. W. fences.
 No find
 4-14-41 - At location indicated by
 random chaining E & W dug 6x10x10
 hole. Did Not find cor. Cor. maybe
 obliterated by drainage ditch
 Cor. in dredge ditch
 6-10-42
 Clearing

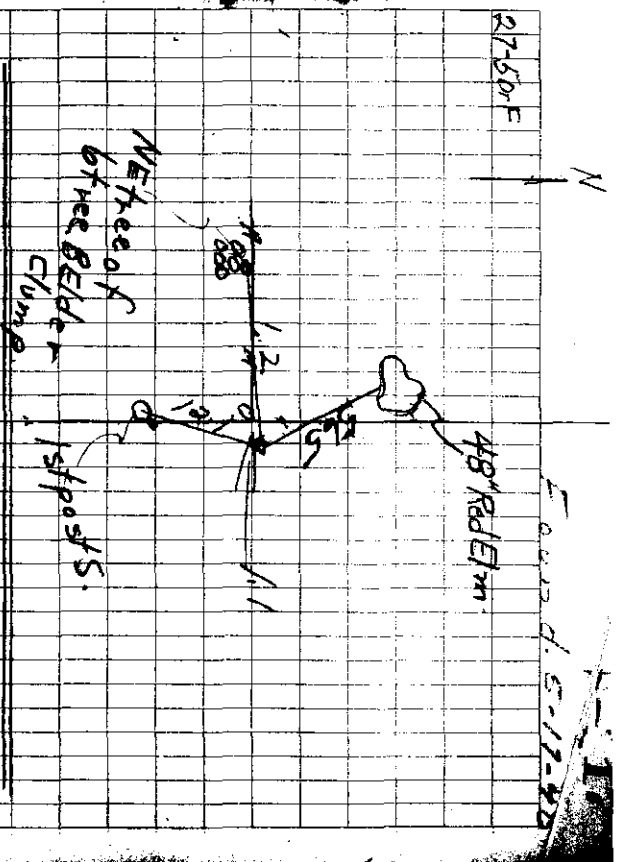

Resought
 Chief
 4-14-41
 Hughes
 Leninger
 Nemits