

FOLLOW UP \_\_\_\_\_  
PROOFED \_\_\_\_\_  
SIGNATURE \_\_\_\_\_

Instrument #: 2013-2821  
11/29/2013 02:29:09 PM Total Pages: 1  
PLC - PLAT CORNER CER  
Recording Fee: \$7.00 Transfer Tax: \$0  
Denise Reeves, Recorder, Crawford County Iowa



PREPARED BY - JOSEPH P. RUESCHENBERG - SUNDQUIST ENGINEERING - 120 S. MAIN, DENISON, IOWA 51442 - PHONE (712) 263-8118

### UNITED STATES PUBLIC LAND SURVEY CORNER CERTIFICATE OF

LAND SURVEY MONUMENT SITUATED IN SECTION 31, T 83 N, R 40 W OF  
THE 5TH P.M., CRAWFORD COUNTY, IOWA.  
PREVIOUSLY RECORDED IN BOOK \_\_\_\_\_, PAGE \_\_\_\_\_, OTHER \_\_\_\_\_

#### MONUMENT DESCRIPTION AND REMARKS

CENTER - SET 5/8" DIA. X 18" IRON PIN W/ORANGE CAP #14709  
FLUSH. SET FROM LOCAL EVIDENCE.

S1/4 CORNER - SET 5/8" DIA. X 18" IRON PIN W/ORANGE CAP  
#14709 0.5' DEEP. SET FROM LOCAL EVIDENCE.

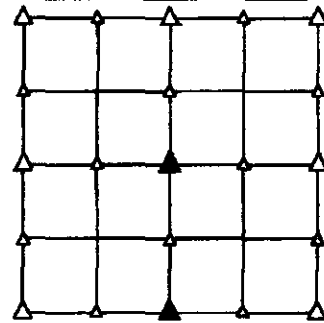

#### PLAN VIEW SHOWING RELATIVE LOCATION OF MONUMENT AND REFERENCE POINTS.

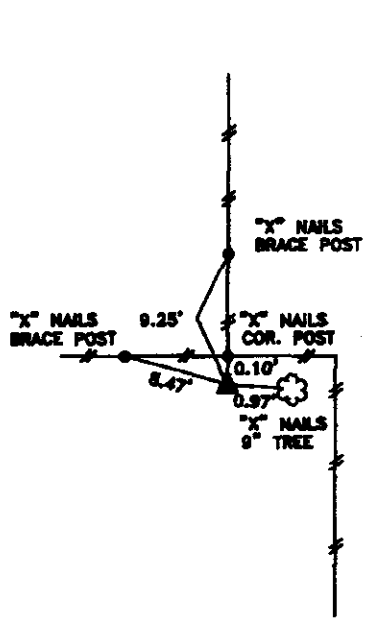

DISTANCES PLUMB CHAINED

CENTER OF SECTION 31-83-40

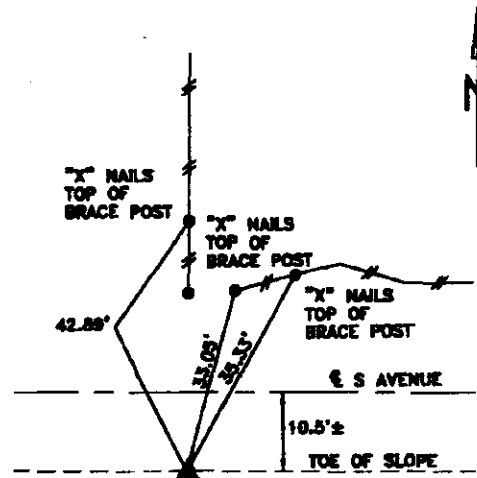

DISTANCES PLUMB CHAINED

S1/4 CORNER SECTION 31-83-40

I HEREBY CERTIFY THAT THIS LAND SURVEYING DOCUMENT WAS PREPARED  
AND THE RELATED SURVEY WORK WAS PERFORMED BY ME OR UNDER MY  
DIRECT PERSONAL SUPERVISION AND THAT I AM A DULY LICENSED LAND  
SURVEYOR UNDER THE LAWS OF THE STATE OF IOWA.

*Joseph P. Rueschenberg* 11-19-2013  
JOSEPH P. RUESCHENBERG DATE

IA LICENSE NO. 14709

EXP. DATE DECEMBER 31, 2014

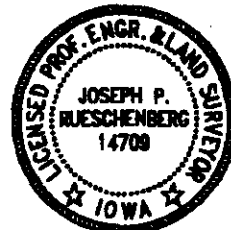

SE PROJECT NO. 23813  
DRAWN BY: LL