

100

24/19 NE Sec 25 T85N R38E

25/30 At location denoted by McHenry Bl. 51, page 26 quot. " - cor. is 34' SE & 34' SW & 42' NW of fence corners - " dug 2 x 3 x 6 hole. Found 12 stones and 9' x 7' x 7" stone on top, 12" deep lower a all evidence and set C.M. Marked 24/19 25/30

Con. Ties

- 34.0 SE of x-spikes in 6" cor. post
- ~~45.5~~ N. of x-spikes in 7" cor. post
- ~~67.5~~ NW of x-spikes in 6" pine post
- ~~79.8~~ SW of x-spikes in 3" cherry tree
- 66.0 NW of x-spikes in tel. pole
- 78.5 SW of x-spikes in REA pole
- 60.4 N.W. of 6" pine post

found set. 9, 1952  
Cates, Wight, Richards - warm.

3-27-41

4/25/58  
med HUB to  
Surface  
D. Lich Miller

Asst. Proj. Engr. Hughes  
Windy - cold  
Frost 12"  
Leminger  
Intenat  
10-9-74 Found C.M.  
30' deep Que-Etteman  
Bendt-Keairnes  
1/2" re-bar over C.M.  
8" deep

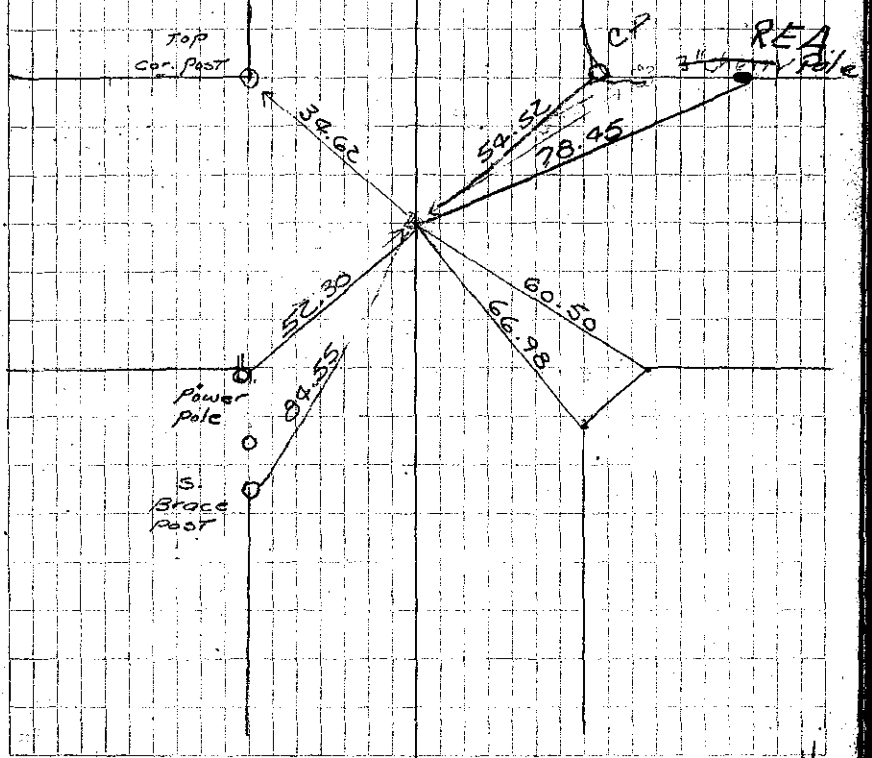

EV