

29 | 28  
32 | 33

NE cor. sec. 32 - T85N-R41W

Sought by ties - ESE #10 - p. 73

Dug 10' x 10' hole and found a split limestone  
6' x 8' x 15" in a depth of 15"

Lovenski evidence and set 1" x 2" wooden  
stake to surface.

Replaced wooden stake with C.M.

Ties from X poles in cor. fc. posts

335 SE

354 SW

461 NW

461 NE

94

Apr. 24, 1939

3-65-A

N  
↑

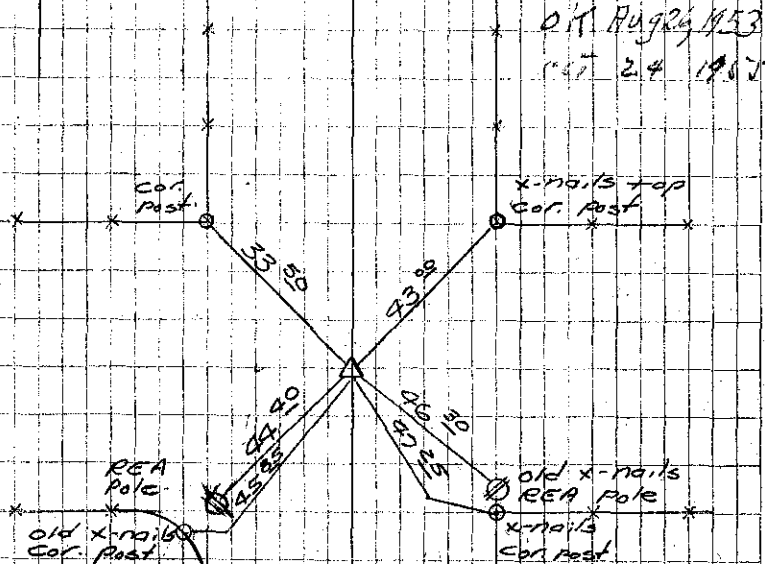

Found B.C. mon. 5 feet deep. Raised  
with 3/4" x 1 1/2" steel pin 0.6' below  
surface. Cor. is 34.0 West of range  
of REA pole line from North.

11-29-72 Hintz, Carsen, & Stevens  
Ties by  
Virtue Engr. Omaha, Iowa