

SECTION CORNER CERTIFICATE

N¹/₄ COR., SEC. 17, T. 85 N, R. 41 W

DESCRIPTION:

DATE 4-25-03

FOUND BASE OF CONC. MON. 48" DEEP.

TOP IS BROKEN OFF & GONE

CONC. BASE LOOKS UNDISTURBED

FOUND 5/8" x 30" REBAR DIRECTLY OVER CENTER OF BASE, 18" DEEP

SET 5/8" x 12" REBAR OVER REBAR. TOP 6" DEEP.

C.M. IS ON LINE WITH FENCE LINE SOUTH.

C.M. IS 3' NORTH OF E E-W GRAVEL

L. STOK, R. ANDERSON

SUNDQUIST ENGINEERING, P.C.

706 IOWA AVE., ONAWA, IOWA 51040

● USE TO SHOW CORNER

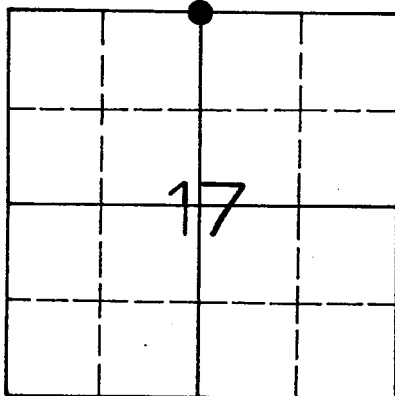

DRAWING

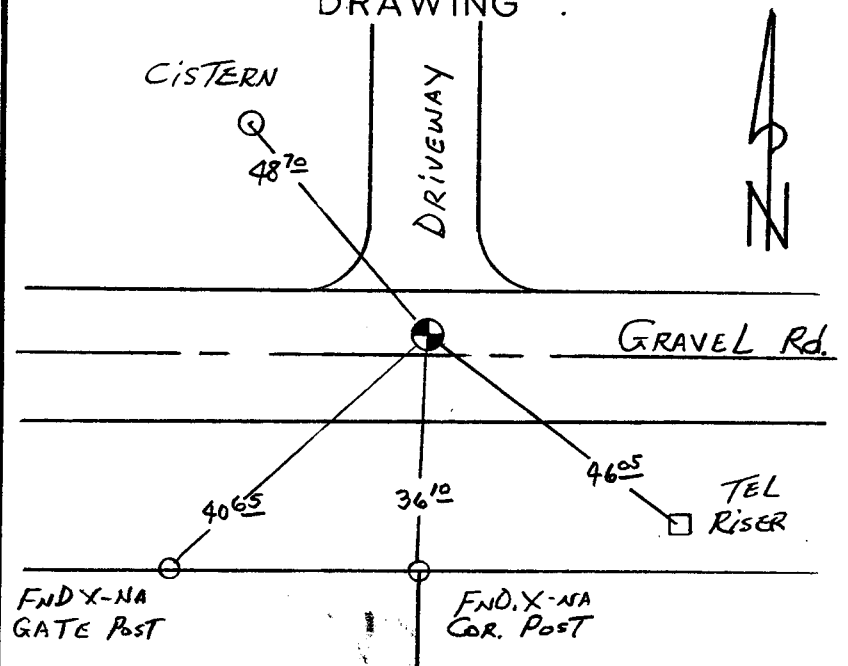

STATE OF IOWA SS
COUNTY OF CRAWFORD

I HEREBY CERTIFY THAT THE SURVEY WORK WAS COMPLETED AND THIS CERTIFICATE WAS PREPARED BY ME OR UNDER MY DIRECT PERSONAL SUPERVISION AND THAT I AM A DULY LICENSED LAND SURVEYOR UNDER THE LAWS OF THE STATE OF IOWA.

3561

LICENSED LAND SURVEYOR NO. 3561

SEAL

April 30, 2003
DATE

THIS SPACE FOR RECORDING OFFICER

FILED DENISON, IOWA
CRAWFORD COUNTY

2003 MAY -1 AM 11:56

INST. NO. 2003-1622
DENISE MEEVES, RECORDER
Denise Meeves
FEE \$ 6.00

INDEXED mm
FOLLOW UP _____
PROCEED _____