

INDEX  
ROLL  
AND  
SCA



Crawford County Recorder Denise Meeves  
Fee Book 2007-1057 REC014210  
04/20/2007 8:10:17AM # Pages 1  
PLC PLAT CORNER CER  
Total Fees: \$7.00



PREPARED BY: PAUL J. ASSMAN - 2130 DELOIT BLVD., DENISON, IOWA 51442 - 712-263-8747

## UNITED STATES PUBLIC LAND SURVEY CORNER CERTIFICATE OF

LAND SURVEY MONUMENT SITUATED IN PARADISE TOWNSHIP, THE CENTER  
OF SECTION 15, T-83N, R-40W OF THE FIFTH P.M. CRAWFORD COUNTY, IOWA.

PREVIOUSLY RECORDED AS NO.

### MONUMENT DESCRIPTION AND REMARKS

CENTER SEC. CORNER 15-83-40

SET 5/8" X 18" REBAR WITH RED CAP #11982 FLUSH WITH GROUND SURFACE.  
SET CORNER NEAR EXISTING CORNER POST RATHER THAN THEORETICAL SPLIT  
AS THE CORNER POST AND CONNECTING FENCES ALL APPEARED TO HAVE BEEN  
AT THEIR PRESENT LOCATION FOR MANY YEARS, AND APPEARED TO ACCURATELY  
REPRESENT THE ORIGINALLY INTENDED SUBDIVISION, AND THE FACT THE CORNER POST  
WAS VERY CLOSE TO THE THEORETICAL SUBDIVISION OF SAID SECTION.

CENTER SEC. CORNER 15-83-40

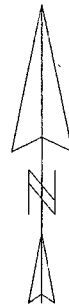
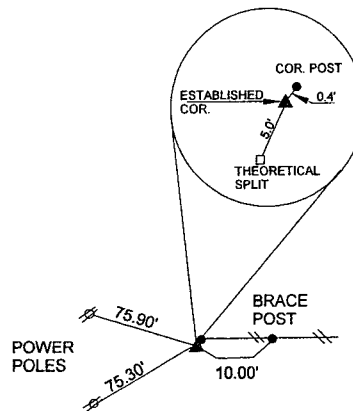

ALL DISTANCES ARE PLUMB CHAINED  
ALL TIES ARE "X" NAILS UNLESS NOTED.

CORNER: CENTER  
SECTION: 15  
TOWNSHIP: 83N  
RANGE: 40W

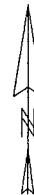
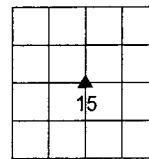

#### CERTIFICATION:

I HEREBY CERTIFY THAT THIS LAND SURVEYING DOCUMENT WAS PREPARED AND THE RELATED SURVEY WORK WAS PERFORMED BY ME OR UNDER MY DIRECT PERSONAL SUPERVISION AND THAT I AM A DULY LICENSED LAND SURVEYOR UNDER THE LAWS OF THE STATE OF IOWA.

Signature

Date of Survey

PAUL J. ASSMAN

11982

Dec. 31, 2008

Typed Name

L.S. No.

License Renewal Date

Pages covered by this seal 1

