

# UNITED STATES PUBLIC LAND SURVEY CORNER CERTIFICATE OF

LAND SURVEY MONUMENT SITUATED IN SECTION 5, T 85 N, R 39 W OF  
THE 5TH P.M., CRAWFORD COUNTY, IOWA.  
PREVIOUSLY RECORDED IN BOOK \_\_\_\_\_, PAGE \_\_\_\_\_, OTHER \_\_\_\_\_

## MONUMENT DESCRIPTION AND REMARKS

N1/4 CORNER - FOUND WOOD STAKE 6" DEEP OVER CM 4' DEEP  
REPLACED EVIDENCE AND SET 5/8" IRON PIN  
W/CAP #8893 6" DEEP

NE CORNER - FOUND 5/8" IRON PIN W/RIBBON 6" DEEP

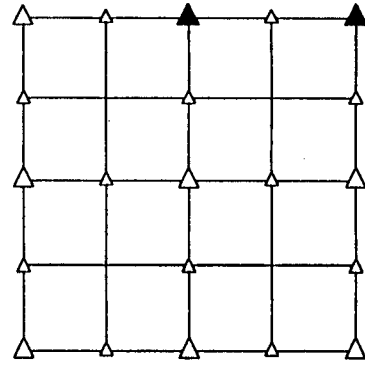

## PLAN VIEW SHOWING RELATIVE LOCATION OF MONUMENT AND REFERENCE POINTS.

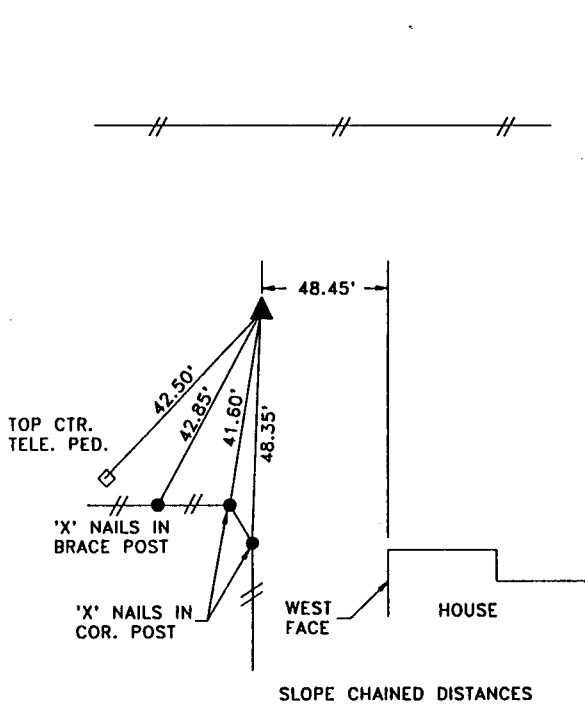

N1/4 CORNER SECTION 5-85-39

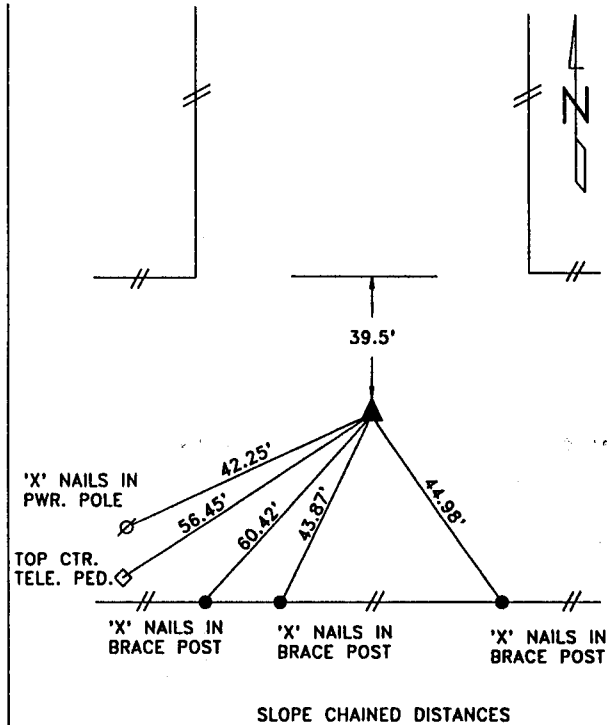

NE CORNER SECTION 5-85-39

I HEREBY CERTIFY THAT THE SURVEY WORK WAS COMPLETED AND THIS LAND SURVEYING DOCUMENT WAS PREPARED BY ME OR UNDER MY DIRECT PERSONAL SUPERVISION AND THAT I AM A DULY LICENSED LAND SURVEYOR UNDER THE LAWS OF THE STATE OF IOWA.

*Terence E. Crawford*  
TERENCE E. CRAWFORD

NOV 22 1996  
DATE

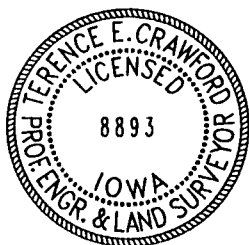

IA LICENSE NO. 8893  
EXP. DATE DECEMBER 31, 1997  
SE PROJECT NO. 2526

SUNDQUIST ENGINEERING, P.C.  
120 SOUTH MAIN, P.O. BOX 220  
DENISON, IOWA 51442 PH. (712)263-8118

## RECORDING OFFICER

FILED DENISON, IOWA  
CRAWFORD COUNTY

96 NOV 26 AM 10:06

INST. NO. 96-3235  
DENISE MEEVES, RECORDER  
*Denise Meeves*  
FEE 6.00

INDEXED  
FOLLOW UP ASAP  
PROCEED