

Crawford County Recorder
 Denise Meeves
Fee Book 2010-1430
 07/09/2010 02:15PM
 PLC PLAT CORNER CER # Pages: 1
 Book: Page: \$0.00
 Total Fees: \$0.00

INDEXED *DM*
 FOLLOW UP *DM*
 PROOFED *DM*
 SCANNED *DM*

PREPARED BY: MICKAEL F. BERNDT - CRAWFORD COUNTY ENGINEER'S OFFICE - COURTHOUSE - DENISON, IA. - 712-283-2449

**UNITED STATES PUBLIC LAND SURVEY CORNER CERTIFICATE
 OF**

LAND SURVEY MONUMENT SITUATED IN NISHNABOTNA TOWNSHIP, THE SOUTHWEST CORNER
 OF SECTION 34, T-82N, R-38W OF THE FIFTH P.M. CRAWFORD COUNTY, IOWA.

PREVIOUSLY RECORDED AS NO.

MONUMENT DESCRIPTION AND REMARKS

SOUTHWEST CORNER SEC. 34-82-38

DATE FOUND: 7-6-10

FOUND 1" REBAR 12" DEEP.
 RETIED CORNER.

SOUTHWEST CORNER SEC. 34-82-38

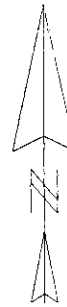
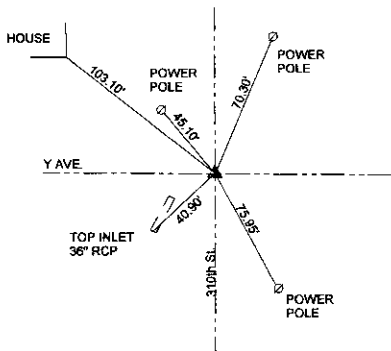

ALL DISTANCES ARE SLOPED CHAINED
 ALL TIES ARE "X" NAILS UNLESS NOTED.

CORNER: SOUTHWEST
 SECTION: 34
 TOWNSHIP: 82N
 RANGE: 38W

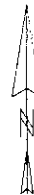
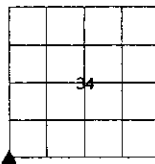

CERTIFICATION:

I HEREBY CERTIFY THAT THIS LAND SURVEYING DOCUMENT WAS PREPARED AND THE RELATED SURVEY WORK WAS PERFORMED BY ME OR UNDER MY DIRECT PERSONAL SUPERVISION AND THAT I AM A DULY LICENSED LAND SURVEYOR UNDER THE LAWS OF THE STATE OF IOWA.

Mickael F. Berndt 7/9/10
 Signature Date of Survey

MICKAEL F. BERNDT 14808 Dec. 31, 2010
 Typed Name L.S. No. License Renewal Date

Pages covered by this seal 1

