

Denise Meeves RECORDER
 Crawford County, Iowa
 Instr. Number: 2021-2444
 Recorded: 10/19/2021 at 4:09:57.0 PM
 Pages 1
 County Recording Fee: \$7.00
 Iowa E-Filing Fee: \$3.13
 Combined Fee: \$10.13
 Revenue Tax:

PREPARED BY AND RETURN TO: MIKE SCHULTE, SCHULTE SURVEYING, INC., 2003 390TH STREET, WESTSIDE, IA 51467 (712) 790-3489

UNITED STATES PUBLIC LAND SURVEY CORNER CERTIFICATE OF

LAND SURVEY MONUMENTS SITUATED IN SECTION 19, TOWNSHIP 82 NORTH, RANGE 38 WEST, OF THE FIFTH PRINCIPAL MERIDIAN, CRAWFORD COUNTY, IOWA. PREVIOUSLY RECORDED IN SEE BELOW IN COUNTY RECORDER'S OFFICE.
(book, page instrument number)

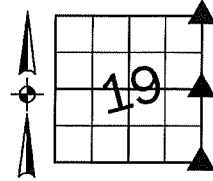

NE CORNER

FND 3/4" REBAR 6" DEEP
 N=7204292.95 E=16616452.47 Z=1424.64

USED CERTIFICATE RECORDED IN INSTRUMENT NO. 2000-1311 AND A METAL DETECTOR TO FIND A 3/4" REBAR 6" DEEP +/-26.70' NORTH OF HIGHWAY 141 CENTERLINE. VERIFIED FOUND MONUMENT WITH 4 REMAINING TIES AND ACCEPTED AS SECTION CORNER.
 THIS CERTIFICATE IS BEING FILED TO UPDATE THE REFERENCE TIES.

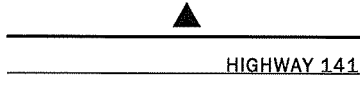

CONCRETE MONUMENT
 134.55'M 134.61'R
 N=7204206.30
 E=16616349.53
 Z=1434.76

CONCRETE MONUMENT
 94.74'M 94.70'R
 N=7204206.89
 E=16616412.82
 Z=1433.13

FND "X" NAILS IN POWER POLE
 90.04'
 N=7204209.46
 E=16616486.20
 Z=1428.96

CONCRETE MONUMENT
 88.15'M 87.98'R
 N=7204211.50
 E=16616486.19
 Z=1425.58

CONCRETE MONUMENT
 124.46'M 124.32'R
 N=7204211.81
 E=16616546.84
 Z=1423.31

SE CORNER

FND 3/4" REBAR 6" DEEP
 N=7199014.49 E=16616449.35 Z=1490.79

USED RECORDED CERTIFICATE TO FIND A 3/4" REBAR 6" DEEP. VERIFIED FOUND MONUMENT WITH 3 REMAINING TIES AND ACCEPTED AS SECTION CORNER.
 THIS CERTIFICATE IS BEING FILED BECAUSE FOUND MONUMENT IS DIFFERENT.

CENTER TELE PED.
 47.85'M 44.50'R
 N=7199048.70
 E=16616415.90
 Z=1490.12

SET "X" NAILS IN POWER POLE
 48.77'
 N=7199048.62
 E=16616484.18
 Z=1492.33

SET "X" NAILS IN CORNER POST
 54.57'
 N=7199050.68
 E=16616490.20
 Z=1492.26

E1/4 CORNER

FND 5/8" REBAR 3" DEEP
 N=7201654.84 E=16616452.19 Z=1397.33

USED RECORDED CERTIFICATE TO FIND A 5/8" REBAR 3" DEEP. VERIFIED FOUND MONUMENT WITH 3 REMAINING TIES AND ACCEPTED AS SECTION CORNER.
 THIS CERTIFICATE IS BEING FILED TO UPDATE THE REFERENCE TIES.

FND "X" NAILS IN FENCE POST
 31.33'M 31.80'R
 N=7201659.94
 E=16616421.28
 Z=1400.47

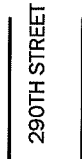

FND "X" NAILS IN CORNER POST
 31.91'M 32.00'R
 N=7201656.15
 E=16616484.07
 Z=1402.75

SET "X" NAILS IN POWER POLE
 90.34'
 N=7201571.36
 E=16616486.72
 Z=1397.64

FND "X" NAILS IN FENCE POST
 40.82'M 40.70'R
 N=7201629.18
 E=16616420.43
 Z=1397.32

SET "X" NAILS IN CORNER POST
 44.37'
 N=7198985.54
 E=16616415.73
 Z=1491.39

STOP SIGN POST
 55.03'M 55.15'R
 N=7198964.76
 E=16616472.94
 Z=1493.67

LIST CORNERS TO BE INDEXED

CORNER	SECTION	TWP	RANGE
NE CORNER	19	82	38
SE CORNER	18	82	38
SW CORNER	17	82	38
NW CORNER	20	82	38
SE CORNER	19	82	38
SW CORNER	20	82	38
NW CORNER	29	82	38
NE CORNER	30	82	38
E1/4 CORNER	19	82	38
W1/4 CORNER	20	82	38

BASIS OF BEARING

1aRCS ZONE 6 - US SURVEY FEET
 1aRTN DERIVED - NAD83(2011)(EPOCH 2010.00)

*All distances are measured horizontally unless noted.

I HEREBY CERTIFY THAT THIS LAND SURVEYING DOCUMENT WAS PREPARED BY ME OR UNDER MY DIRECT PERSONAL SUPERVISION AND THAT I AM A DULY LICENSED PROFESSIONAL LAND SURVEYOR UNDER THE LAWS OF THE STATE OF IOWA.

Mike Schulte
 MIKE SCHULTE
 2021/10/19
 DATE
 LICENSE NUMBER: 17979
 LICENSE RENEWAL DATE IS DECEMBER 31, 2021
 PAGES COVERED BY THIS SEAL: 1 OF 1

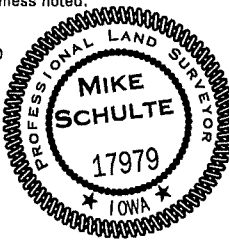

SCHULTE SURVEYING, INC.

DRAWN BY: MLS
 PROJ NUMBER: 21-076