

31/32  
6/5

Found C.M. set by a former  
I.B.S. crew. (Perhaps Ida Co.  
Crew under Cox) We do  
not have any record of  
corner in Crawford Co. files.  
We dug out C.M. to  
see if there was  
old evidence in position  
of hole. We found none  
So corner was apparently  
established.  
Took new ties from x spks

Ties from X nails

- 42.4 S.E. from Cor Post
- 64.2 S.E. from first Steel Post N.
- 58.2 S.W. from Cor. P.O.
- 38.3 N.W. of Brace Post E.
- 29.7 N.W. of Cor. Post
- 35.4 N.W. of Brace Post E.
- Conc. Manu. is G.S.' S. of fence W.
- Conc. Manu. is G.S.' S. of Rd. E.

Refound 6-25-42  
Walter - Kasse, Eng  
Chief - Champion  
C. V. - F. A. -

3/24/86 Found Conc Manu broken off  
10" deep, raked Kearnes, Bendt

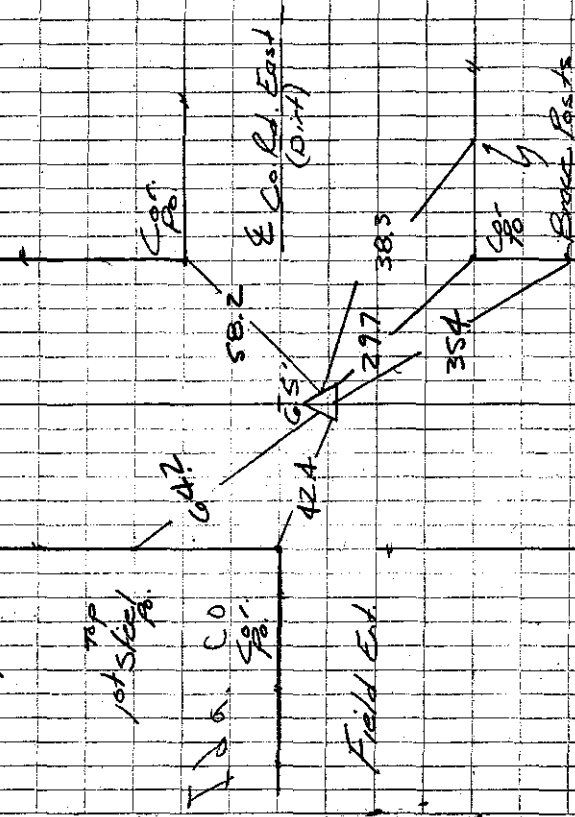

Cor is 8.4 S of Fe from West  
OK 7-14-65 20" DEEP  
2' x 2' x 12" Tacked Hub above C.M.