

Cold & Damp
 6-25-72
 Lead Clapnet
 Chisel Churn pump

0.17.11.1930

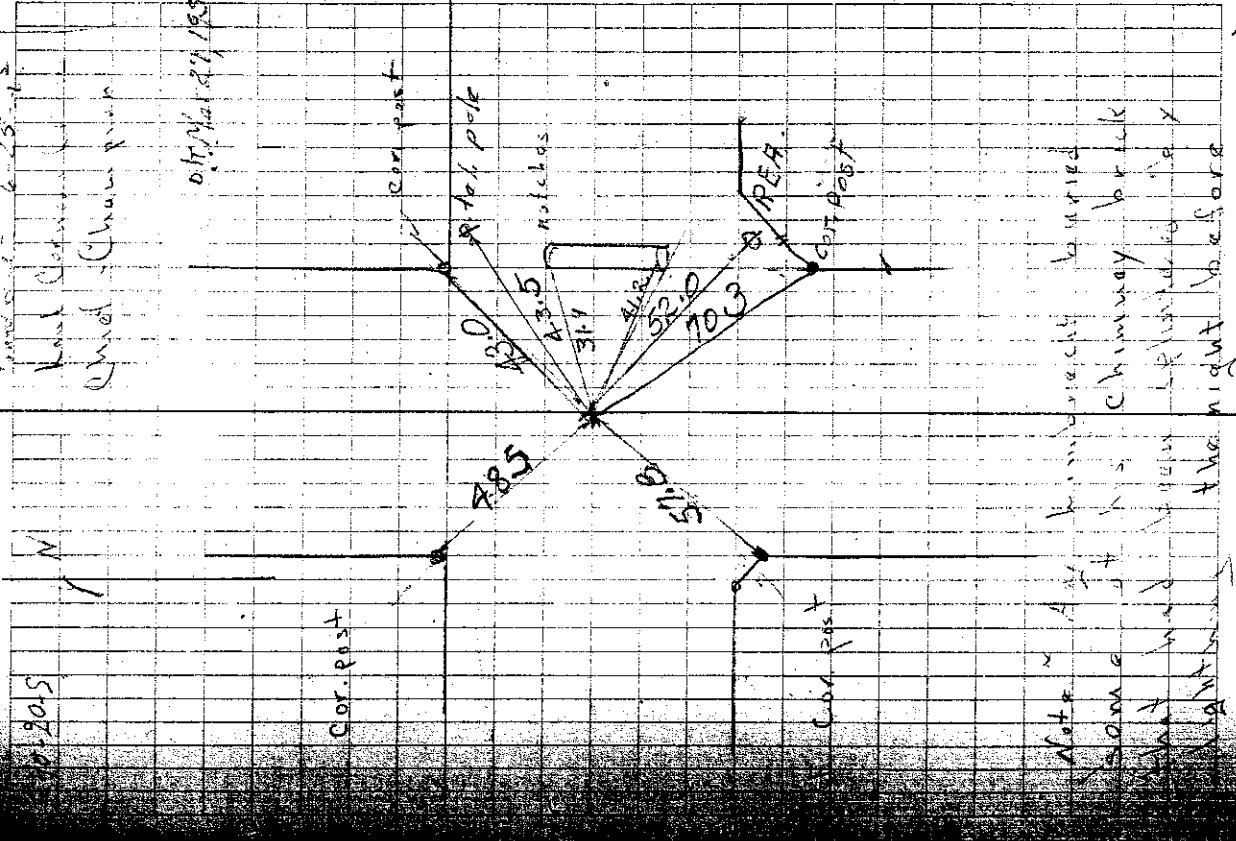

33 34 NE Cor 4
 43 8-18-39 Dug 10' dia hole
 in center of Inter. sec / bend
 1 piece of brick 2 1/2" x 3" dug
 below but no other evidence
 Replaced brick where found
 Found 1/4" x 13" piece of rebar
 steel in wall
 Apparently piece of rebar is
 Survey. Rebar is a well
 set to this corner of field
 evidence checked later 4/4/72
 Lower line set C.M.
 about 13" below surface of
 road
 trees from X-Spts

57.8 NE of E cor. post
 48.5 SE of Cor. post
 43.0 SW of Cor. post
 43.5 SW of Tel. pole
 31.9 SW of N end of culvert
 81.2 NW of S end of culvert
 Note ~ A. W. K. chimney brick buried
 same as it is chimney brick
 that had been left behind the
 night before