

INDEXED
 FOLLOW UP
 FILED
 SERIALIZED

Crawford County Recorder
 Denise Meeves
Fee Book 2013-1640
 07/12/2013 011:35AM
 PLC PLAT CORNER CER # Pages: 1
 Book: Page: \$7.00
 Total Fees: \$7.00

PREPARED BY - JAMES C. SAILER - IDOT. P.O.B. 987, SIOUX CITY IOWA 51102-0987 PHONE (712) 276-1451



UNITED STATES PUBLIC LAND SURVEY CORNER CERTIFICATE
 OF



Land Survey Monument Situated in Section 36,
 Township 85 NORTH, Range 40 WEST Of The Fifth Principal Meridian,
 CRAWFORD County, Iowa. Previously Recorded In _____
 In The County Recorders Office.

Monument Description and Remarks:

- ① E 1/4 CORNER SEC 36-85-40. FOUND 3/4" PIPE, 2" DEEP IN SHOULDER. SET IDOT BRONZE DISK W/ CUT TRIANGLE IN NEW ASPHALT OVERLAY.
- ② NE CORNER SEC 36-85-40. FOUND IDOT ALUM DISK IN ACC. SET IDOT BRONZE DISK W/ CUT TRIANGLE IN NEW ASPHALT OVERLAY.

PLAN - VIEW

① E 1/4 CORNER SEC 36-85-40

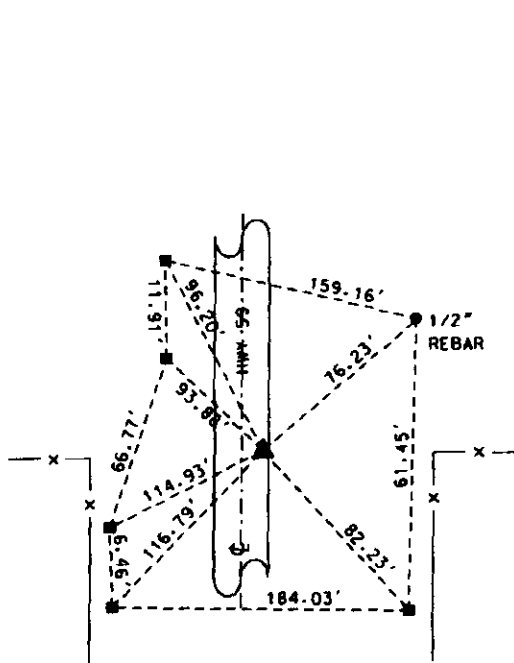

■ = CONCRETE MONUMENT

② NE CORNER SEC 36-85-40

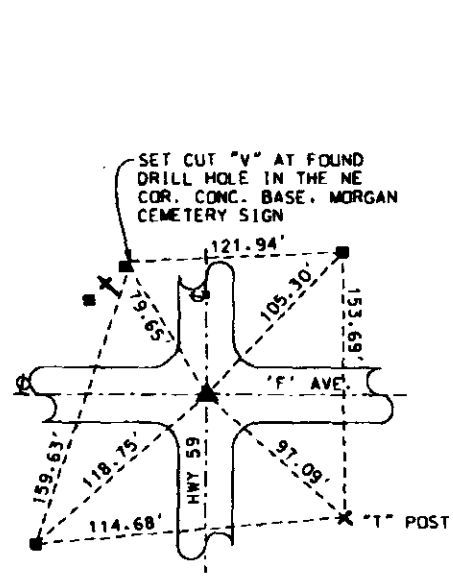

■ = CONCRETE MONUMENT

I hereby certify that this land surveying document was prepared and the related survey work was performed by me or under my direct personal supervision and that I am a duly licensed Professional Land Surveyor under the Laws of the State of Iowa.

Signature: *James C. Sailer* Date: *7/16/13*
 James C. Sailer - Lisc. No. 12090



My License Renewal Date is December 31, 2014
 Pages or sheets covered by this seal: 1

IOWA DEPARTMENT OF TRANSPORTATION
 CRAWFORD COUNTY FIELD BOOK 1 . PAGE 85.87
 CERTIFICATE NUMBER 24-09

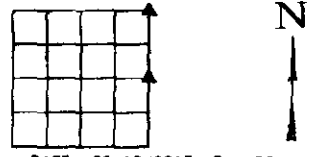

DATE: 06/12/2013 BY: COM

Corner	Section	Twp	Range
E 1/4	36	85	40
NE	36	85	40