

INDEXED SM 1572
FOLLOW UP _____
PROOFED _____
SCANNED _____

Crawford County Recorder
Denise Meeves
Fee Book 2013-2023
08/22/2013 @11:44AM
PLC PLAT CORNER CER # Pages: 1
Book: Page: \$0.00
Total Fees: \$0.00

PREPARED BY: PAUL ASSMAN-CRAWFORD COUNTY ENGINEER'S OFFICE-COURTHOUSE-DENISON, IA.-712-263-2449

**UNITED STATES PUBLIC LAND SURVEY CORNER CERTIFICATE
OF
LAND SURVEY MONUMENT SITUATED IN MORGAN TOWNSHIP, THE NORTH 1/4 CORNER OF SECTION 27, T-85N,
R-40W OF THE FIFTH P.M. CRAWFORD COUNTY, IOWA.**

PREVIOUSLY RECORDED AS NO. 2011-1859

MONUMENT DESCRIPTION AND REMARKS

NORTH 1/4 CORNER SEC. 27-85-40

FOUND 5/8" REBAR 10" DEEP.
COUNTY GRADED ROAD AND SET 5/8" X 18" REBAR WITH
RED CAP #11982 1.0' DEEP.

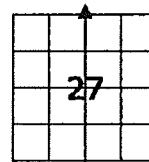

NORTH 1/4 CORNER SEC. 27-85-40

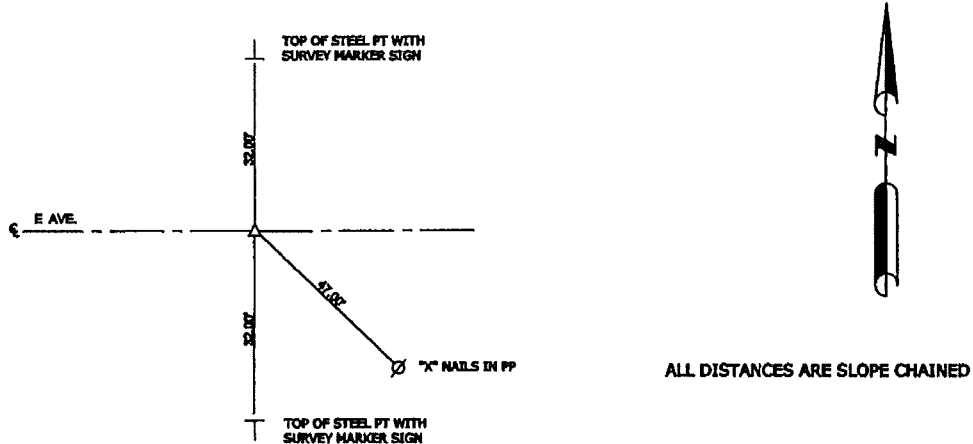

CERTIFICATION:
I HEREBY CERTIFY THAT THIS LAND SURVEYING DOCUMENT WAS PREPARED AND THE RELATED SURVEY WORK WAS PERFORMED BY ME OR UNDER MY DIRECT PERSONAL SUPERVISION AND THAT I AM A DULY LICENSED LAND SURVEYOR UNDER THE LAWS OF THE STATE OF IOWA.

Paul J. Assman 7/17/13
Signature Date of Survey

PAUL J. ASSMAN 11982 12-31-14
Typed Name L.S. No. License Renewal Date

Pages covered by this seal 1

