

INDEXED KM
 FOLLOW UP _____
 PROOFED _____
 SCANNED _____

Instrument #: 2018-1937
 09/19/2018 08:27:33 AM Total Pages: 1
 PLC PLAT CORNER CER
 Recording Fee: \$0.00 Transfer Tax: \$0
 Denise Meeves, Recorder, Crawford County Iowa



PREPARED BY: PAUL ASSMAN-CRAWFORD COUNTY ENGINEER'S OFFICE-COURTHOUSE-DENISON, IA.-712-263-2449

UNITED STATES PUBLIC LAND SURVEY CORNER CERTIFICATE OF

LAND SURVEY MONUMENT SITUATED IN MORGAN TOWNSHIP, THE NORTHEAST CORNER OF SECTION 16, T-85N,
R-40W OF THE FIFTH P.M. CRAWFORD COUNTY, IOWA.

NOT PREVIOUSLY RECORDED. FOUND ON PG. 46 OF MORGAN(1) TWP FIELD BOOK, IN ENGINEER'S OFFICE.

MONUMENT DESCRIPTION AND REMARKS

NORTHEAST CORNER SEC. 16-85-40

FOUND 1" IRON PIN 0.5' DEEP IN ACCORDANCE WITH PREVIOUS TIES. COUNTY GRADED RD, PROJECT NO. LG50-16N. VERIFIED THAT CORNER WAS UNDISTURBED AND RETIED CORNER.

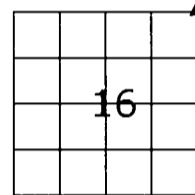

NORTHEAST CORNER SEC. 16-85-40

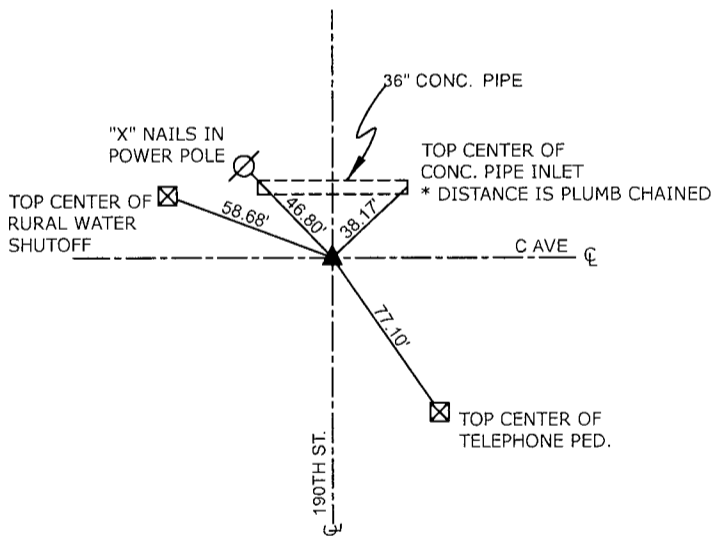

ALL DISTANCES ARE SLOPE CHAINED UNLESS NOTED OTHERWISE

CERTIFICATION:

I HEREBY CERTIFY THAT THIS LAND SURVEYING DOCUMENT WAS PREPARED AND THE RELATED SURVEY WORK WAS PERFORMED BY ME OR UNDER MY DIRECT PERSONAL SUPERVISION AND THAT I AM A DULY LICENSED LAND SURVEYOR UNDER THE LAWS OF THE STATE OF IOWA.

Paul J. Assman 7/31/18
 Signature Date of Survey

PAUL J. ASSMAN 11982 12-31-18
 Typed Name L.S. No. License Renewal Date

