

COPY

INDEXED  
FOLLOW UP  
PROGRESSED  
SEARCHED

PREPARED BY: JOHN A. MUNSON III - SUNDQUIST ENGINEERING - 910 SEVENTH STREET, ONAWA, IOWA 51040-PHONE (712)423-3131

**UNITED STATES PUBLIC LAND SURVEY CORNER CERTIFICATE OF**  
LAND SURVEY MONUMENT SITUATED IN SECTION 15, TOWNSHIP 85 NORTH, RANGE 40 WEST  
OF THE FIFTH PRINCIPAL MERIDIAN, CRAWFORD, COUNTY, IOWA.  
PREVIOUSLY RECORDED IN \_\_\_\_\_ IN COUNTY RECORDERS OFFICE.

**MONUMENT DESCRIPTION AND REMARKS**

NORTH QUARTER CORNER SECTION 15-85-40

FOUND 5/8" REBAR 0.10' DEEP.

REBAR FITS CENTERLINE OF EAST/WEST ROAD.

L. STUKENHOLTZ & R. ANDERSON

DATE 01-26-09

**PLAN VIEW**

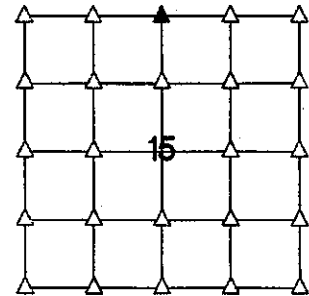
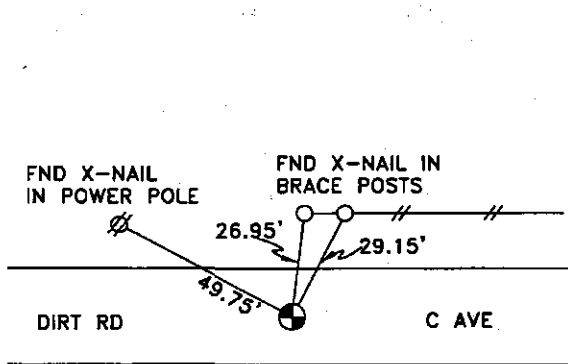

I HEREBY CERTIFY THAT THIS LAND SURVEYING DOCUMENT AND THE RELATED SURVEY WORK WAS PERFORMED BY ME OR UNDER MY DIRECT PERSONAL SUPERVISION AND THAT I AM A DULY LICENSED LAND SURVEYOR UNDER THE LAWS OF THE STATE OF IOWA.

John A. Munson III 2-4-09  
JOHN A. MUNSON III DATE

IA. LICENSE NO. 11118

EXP. DATE DECEMBER 31, 2010

SE PROJECT NO. 30809T1

DRAWN BY: CSL

