

98 JUL 10 PM 4:09

INST. NO. 98-2143
DENISE MEEVES, RECORDER
Denise Meeves
FEE 6.00

INDEXED
FOLLOW UP
PROCESSED

PREPARED BY: CHARLES A. TAPLEY L.S., KUEHL & PAYER LTD., P.O. BOX 458, 1725 N. LAKE AVE., STORM LAKE, IOWA 50588 TELEPHONE: (712)732-8292

UNITED STATES PUBLIC LAND SURVEY CORNER CERTIFICATE
OF

LAND SURVEY MONUMENTS SITUATED IN SECTION 14 TOWNSHIP 85 NORTH
RANGE 40 WEST OF THE 5TH PRINCIPAL MERIDIAN, CRAWFORD COUNTY, IOWA

PREVIOUSLY RECORDED IN BOOK _____ PAGE _____

MONUMENT DESCRIPTION AND REMARKS: _____

- 1) W 1/4 CORNER 14-85-40: FD. AXEL 4" DEEP
- 2) NW CORNER 14-85-40: FD. AXEL 10" DEEP
- 3) N 1/4 CORNER 14-85-40: FD. 1/2" REBAR 20" DEEP; RASIED WITH 1/2" REBAR 4" DEEP

PLAN - VIEW

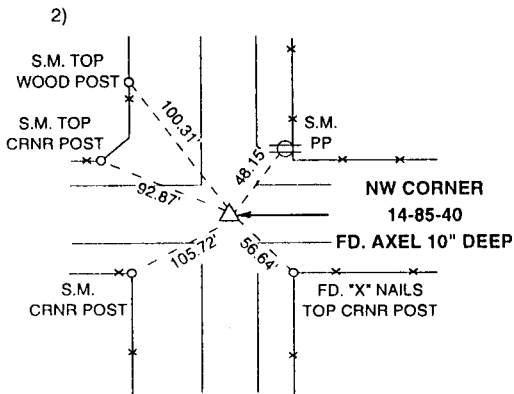
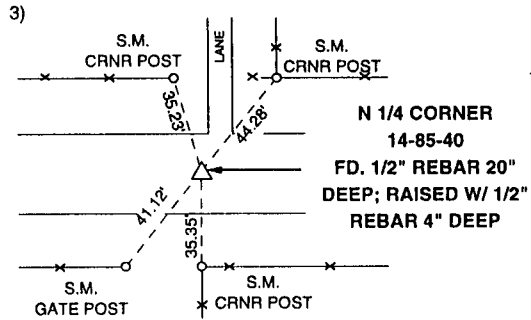
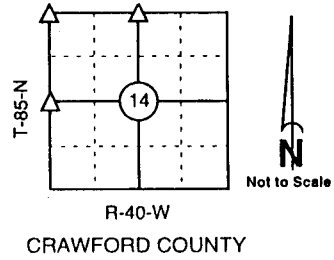
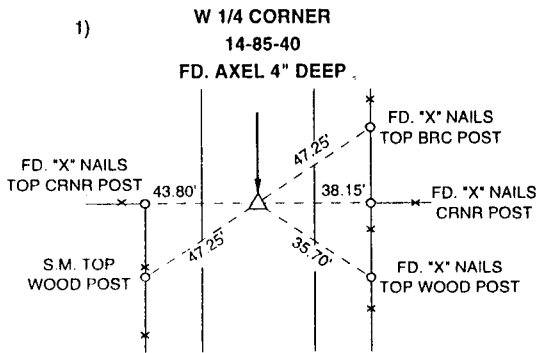

S.M. = SURVEY MARKER
PLASTIC DISK AS SHOWN BELOW



I hereby certify that this land surveying document was prepared and the related survey work was performed by me or under my direct personal supervision and that I am a duly licensed Land Surveyor under the laws of the State of Iowa.

Charles A. Tapley 7/15/98
Charles A. Tapley Date
License Number 5688
My license renewal date is December 31, 1998
Pages covered by this seal: 1

List Corners to be Indexed

Corners	Section	Twp.	Range
1) W 1/4	14	85	40
2) NW	14	85	40
3) N 1/4	14	85	40

PN: 980079
DRAWN: JMK