

Soc. Co.
32/33
5/4

NE Cor-S

Dauphin Co.

Found laths and 10" diam. rock
2" below guide, tin can, barbed
wire glass, and 12" diam rock
at a depth of 14" lowered and
set conc man.

Ties from r. spl. in cor. to p.
66.2' NE of cor post
15.2' NW (to line W) cor post
21.5' S. of cor post

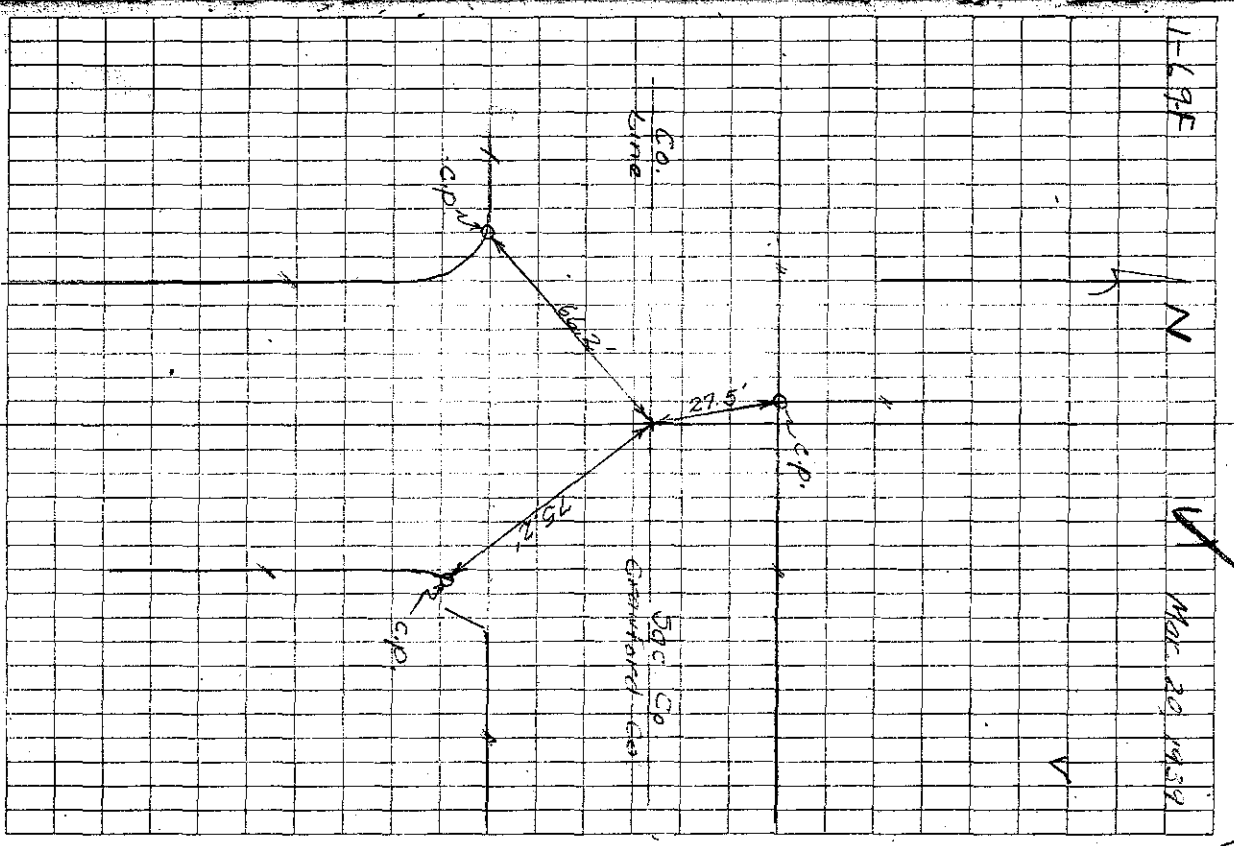

EN