

34 35 NE Oct 3

3 2 Dog 3 1/4" hole and found 3/8" rod 3'
 Long at a depth of 12" Lower and set
 C.M.

Ties from "X" nails

73.30 S.E. from top w. Gate Post
 58.55 N.E. from w. Brace Post
 60.35 S.W. from Cor Post
 46.35 NW from Power Pole

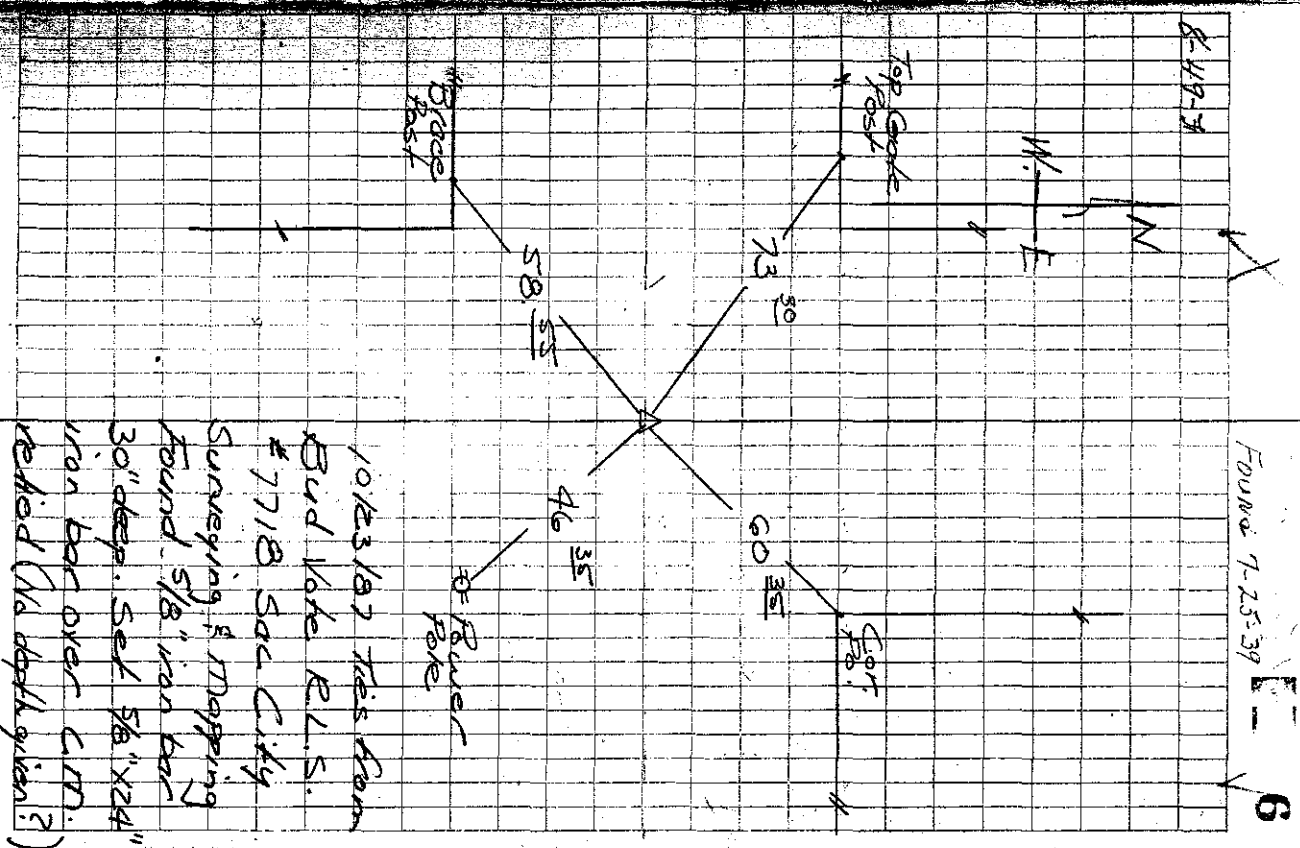

Found 7-25-39

6

10/23/87 Ties from
 Bud Wake R.L.S.
 # 7718 Sac City
 Surveying & Mapping
 Found 5/8" iron bar
 30" deep. Set 5/8" x 24"
 iron bar over C.M.
 rebar (No depth given?)

EN