

Found 2.9

29.28 Dug 2x2' hole and found few pieces
of brick at a depth of 2" Remains
Of Walnut stake about 16" long at a depth
3' Lowered and set C.M.

Lies from X SPIKES 17 COR POSTS

33.8 SE from tele pole

33.9 NE " " " 24 POSTS.

36.5 NW " " " 1st steel post

27.5 W " " " Cor Post

N CONVOY

20 Dug 3x5x16' hole in line of N+S
29 fences. No find

8-67-3

N

Found 7-28-39

59

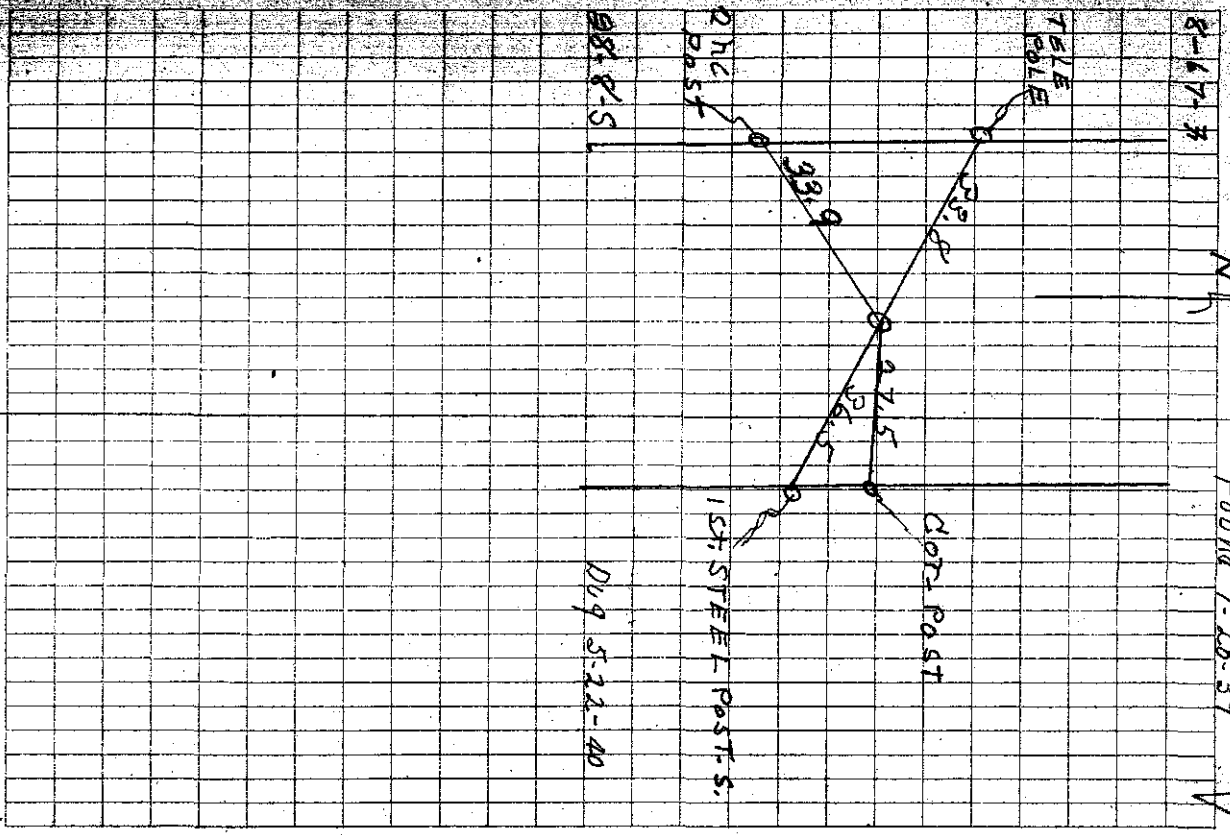

13