

E Cor. 24

24/19 Dug 4x8' hole Found Lath at Surface  
 0' to ad. Estab. Corner 7-25-39 Set C.M.  
 from Carroll County Pie Notes Iron Stake  
 25.1 E of Cor

Ties from x SPIKES in Cor Posts

42.4 N.E. from Steel Post Stake

32.9 E from Cor Post

27.0 W. . . . . 5-2-73 checked & Retied

6-11-70 Insta Ties (Cue)

(Kruze)

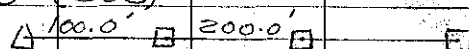

All distances Plumb Chained 2"x2" Tacked Hubs

13 N 3/4 24

24 Dug hole 5x12x16"

No Find Found remains of old  
 point stake at a depth of 4'. Top of  
 stake had been destroyed by  
 previous digging. Found point of  
 stake set C.M.

Ties from Cor Post

27.8 S from cor post

29.2 N . . . . .

181.5 N . . . . . willow stump

41.2 SE from 2nd post W

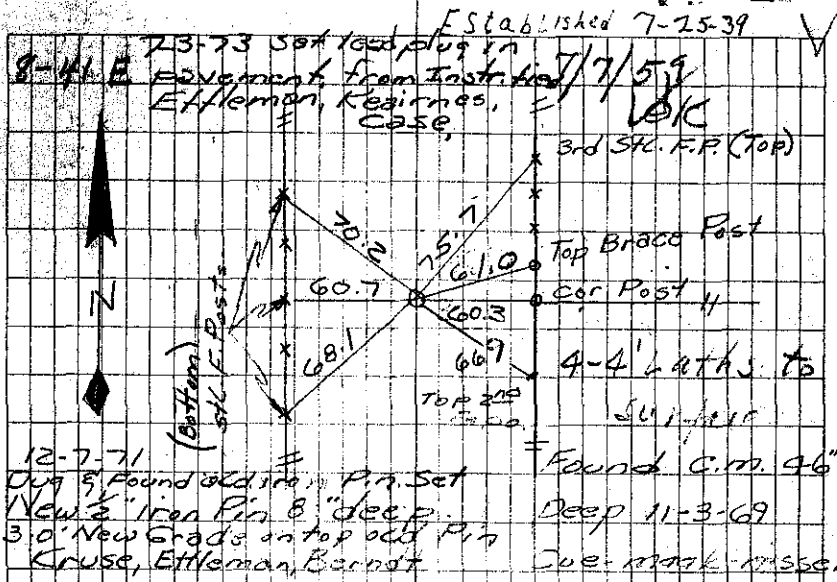

5-39-SN

Dug 6-16-39

