

**UNITED STATES PUBLIC LAND SURVEY CORNER CERTIFICATE
OF**

Land Survey Monuments situated in Section 22, Township 85, Range 37, of the Fifth Principal Meridian, Crawford County, Iowa. Previously recorded in _____ in County Recorder's Office.
(book, page, document number, etc.)

(Show reason for preparing this certificate, the evidence and detailed procedures used in establishing the corner positions and monumentation found or placed.)

PLAN - VIEW

(Show a minimum of three reference ties to durable physical objects, relevant monuments and physical conditions that will enable recovery of the corner.)

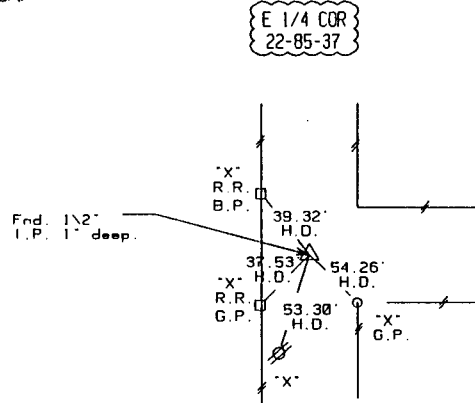

E 1/4 COR
22-85-37

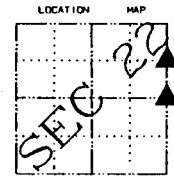

NOTE:
H.D. =
HORIZONTAL
DISTANCE

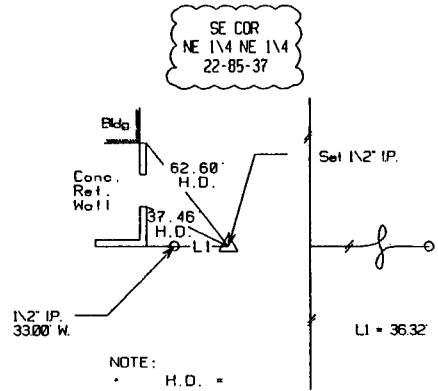

SE COR
NE 1/4 NE 1/4
22-85-37

NOTE:
H.D. =
HORIZONTAL
DISTANCE

FILED DENISON, IOWA
CRAWFORD COUNTY

95 OCT -3 AM 10:21

INST. NO. 95-2361
DENISE HEEVES, RECORDER
Denise Heeves
FEE: \$6.00

INDEXED _____
FOLLOW UP SEMKE
PROOFED _____

I HEREBY CERTIFY THAT THIS CORNER CERTIFICATE WAS PREPARED BY ME OR UNDER MY DIRECT PERSONAL SUPERVISION AND THAT I AM A DULY REGISTERED LAND SURVEYOR UNDER THE LAWS OF THE STATE OF IOWA. MY REGISTRATION EXPIRES 12-31-95.

10-2-95
DATE

Micheal G. Semke
MICHEAL G. SEMKE, RLS NO 10318

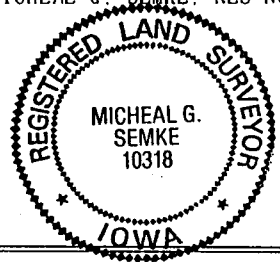

List Corners to be Indexed			
Corners	Section	Twp	Range
E 1/4	22	85	37
W 1/4	23	85	37
SE COR			
NE 1/4			
NE 1/4	22	85	37
NW COR			
SW 1/4			
NW 1/4	23	85	37