

2000 APR 28 AM 11:17

INST. NO. 200-1090
DENISE MUEVES, RECORDER
Denise Mueves
FEE 6.00

This document prepared by: Semke & Associates - 712-792-2276
Michael G. Semke, L.S.#10318 - 608 N. Court St., Carroll, Iowa

UNITED STATES PUBLIC LAND SURVEY CORNER CERTIFICATE
OF

Land Survey Monuments situated in Section 23, Township 83, Range 37, of the Fifth Principal Meridian, Crawford County, Iowa. Previously recorded in n/a in County Recorder's Office.
(book, page, document number, etc.)

(Show reason for preparing this certificate, the evidence and detailed procedures used in establishing the corner positions and monumentation found or placed.)

Found 5/8" iron pin 12" deep which corresponds reasonably with Crawford Co., Engineer tie book information. Raised corner to 3" depth with 80-d.x 10" spike.

PLAN - VIEW

(Show a minimum of three reference ties to durable physical objects, relevant monuments and physical conditions that will enable recovery of the corner.)

SW COR
23-83-37

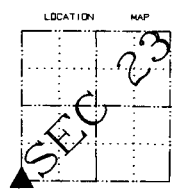

L1=Notch in 24" CMP
33.26' horizontal distance

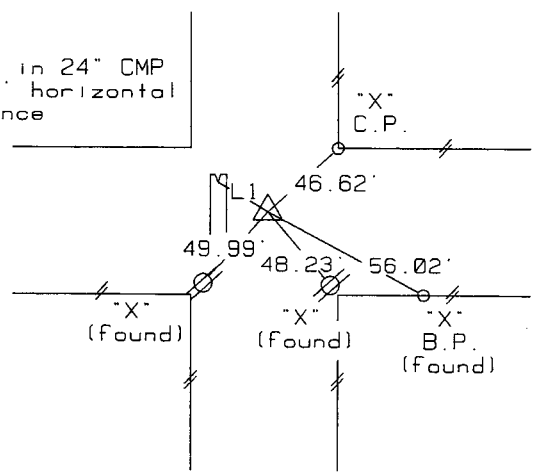

Note: All ties slope chained unless noted.

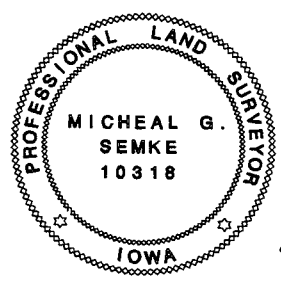

I HEREBY CERTIFY THAT THIS CORNER CERTIFICATE WAS PREPARED BY ME OR UNDER MY DIRECT PERSONAL SUPERVISION AND THAT I AM A PROFESSIONAL LAND SURVEYOR UNDER THE LAWS OF THE STATE OF IOWA. MY REGISTRATION IS SUBJECT TO RENEWAL 12-31-01.

4/27/00
DATE

Michael G. Semke
MICHAEL G. SEMKE, RLS NO 10318

List Corners to be Indexed			
Corners	Section	Twp	Range
SW COR	23	83	37
SE COR	22	83	37
NE COR	27	83	37
NW COR	26	83	37