

Sara Meseck, RECORDER
 Crawford County, Iowa
 Instr. Number: 2023-2135
 Recorded: 12/4/2023 at 1:59:57.0 PM
 Pages 1
 County Recording Fee: \$7.00
 Iowa E-Filing Fee: \$3.13
 Combined Fee: \$10.13
 Revenue Tax:

PREPARED BY AND RETURN TO: MIKE SCHULTE, SCHULTE SURVEYING, INC., 2003 390TH STREET, WESTSIDE, IA 51467 (712) 790-3489

UNITED STATES PUBLIC LAND SURVEY CORNER CERTIFICATE OF
 LAND SURVEY MONUMENTS SITUATED IN SECTION 23, TOWNSHIP 83 NORTH, RANGE 37 WEST, OF THE FIFTH
 PRINCIPAL MERIDIAN, CRAWFORD COUNTY, IOWA. PREVIOUSLY RECORDED IN SEE BELOW IN COUNTY
(book, page instrument number)
 RECORDER'S OFFICE.

CENTER OF SECTION
 FND 1/2" REBAR AT THE SURFACE
 N=7233583.92 E=16666437.72 Z=1426.10
 USED CERTIFICATE RECORDED IN INSTRUMENT #2000-1088 TO
 FIND A 1/2" REBAR AT THE SURFACE. VERIFIED WITH 1
 REMAINING TIE.
 THIS CERTIFICATE IS BEING FILED TO UPDATE THE REFERENCE TIES.

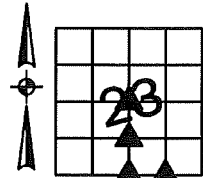

SW CORNER NW1/4 SE1/4
 FND 1/2" REBAR YPC #10318
 N=7232270.22 E=16666433.34 Z=1449.52
 NO RECORDED CERTIFICATE FOUND. FOUND 1/2" REBAR YPC
 #10318. VERIFIED WITH PLAT OF SURVEY RECORDED IN FEE
 BOOK 2006-1885.
 THIS CERTIFICATE IS BEING FILED DUE TO NONE OF RECORD.

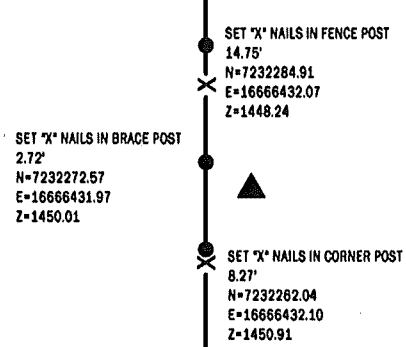
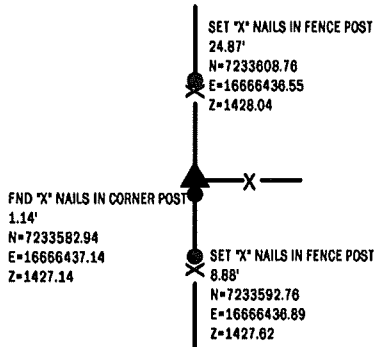

S1/4 CORNER
 FND CONCRETE MONUMENT
 N=7230956.52 E=16666428.97 Z=1441.85
 USED CERTIFICATE RECORDED IN INSTRUMENT #2000-1089 TO FIND A
 CONCRETE MONUMENT 24" DEEP. VERIFIED WITH 2 REFERENCE TIES.
 SET 12" X 5/8" REBAR YPC #17979 OVER CONCRETE MONUMENT.
 THIS CERTIFICATE IS BEING FILED DUE TO THE ADDITION OF REBAR
 OVER FOUND MONUMENT.

SE CORNER SW1/4 SE1/4
 SET 5/8" REBAR YPC #17979
 N=7230947.16 E=16667745.98
 NO RECORD OF CORNER FOUND. SEARCHED AREA, FOUND
 NOTHING. SET 5/8" REBAR YPC #17979 BY SINGLE PROPORTION.
 THIS CERTIFICATE IS BEING FILED DUE TO NONE OF RECORD.

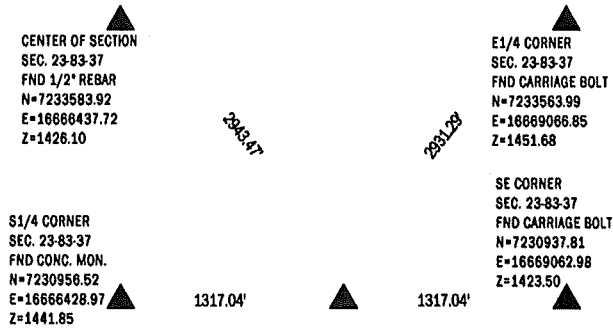
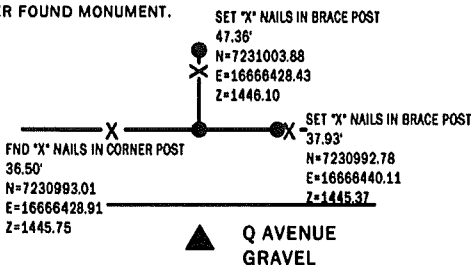

*All distances are measured horizontally unless noted.

I HEREBY CERTIFY THAT THIS LAND SURVEYING DOCUMENT WAS
 PREPARED BY ME OR UNDER MY DIRECT PERSONAL SUPERVISION AND
 THAT I AM A DULY LICENSED PROFESSIONAL LAND SURVEYOR UNDER
 THE LAWS OF THE STATE OF IOWA.

Mike Schulte
 MIKE SCHULTE
 LICENSE NUMBER: 17979
 LICENSE RENEWAL DATE IS DECEMBER 31, 2023
 PAGES COVERED BY THIS SEAL: 1 OF 1



LIST CORNERS TO BE INDEXED

CORNER	SECTION	TWP	RANGE
CENTER OF SECTION	23	83	37
S1/4 CORNER	23	83	37
N1/4 CORNER	26	83	37
SW CORNER NW1/4 SE1/4	23	83	37
SE CORNER SW1/4 SE1/4	23	83	37
NE CORNER NW1/4 NE1/4	26	83	37

BASIS OF BEARING
 IARCS ZONE 8 - US SURVEY FEET
 IARCN DERIVED - NAD83(2011)(EPOCH 2010.00)

SCHULTE SURVEYING, INC.

DRAWN BY: MLS/SLG
 PROJ NUMBER: 23-099