

16-15 9-3-40-Dug-2'x6'x6' hole  
in line of E+W fences.  
No find

(OLD NOS)

- 9-3-40-Dug-2'x6'x6' hole  
1/6 in line of W fence road  
boss says con was graded  
out by hilly, later - A hole dug on  
S E. found nothing. Esth. on line of E S at  
dist. from ctr See 9 given by McHenry Bk 24 p 33-32,  
26268 Dist from ctr see 16-2628' See 149 for Esth  
cl. This from "X" nails  
31.2 5.E. from Wood Brace Post  
32.0 S.W. from Con Post  
30.7 S.W. from Wood Fence Post  
34.5 N. from Con Post  
28.1 N.E. from NE. Can Lid REC Box  
41.2 N.E. from Wood Brace Post

Retired from Sec.  
Con. Cert. 10/23/98

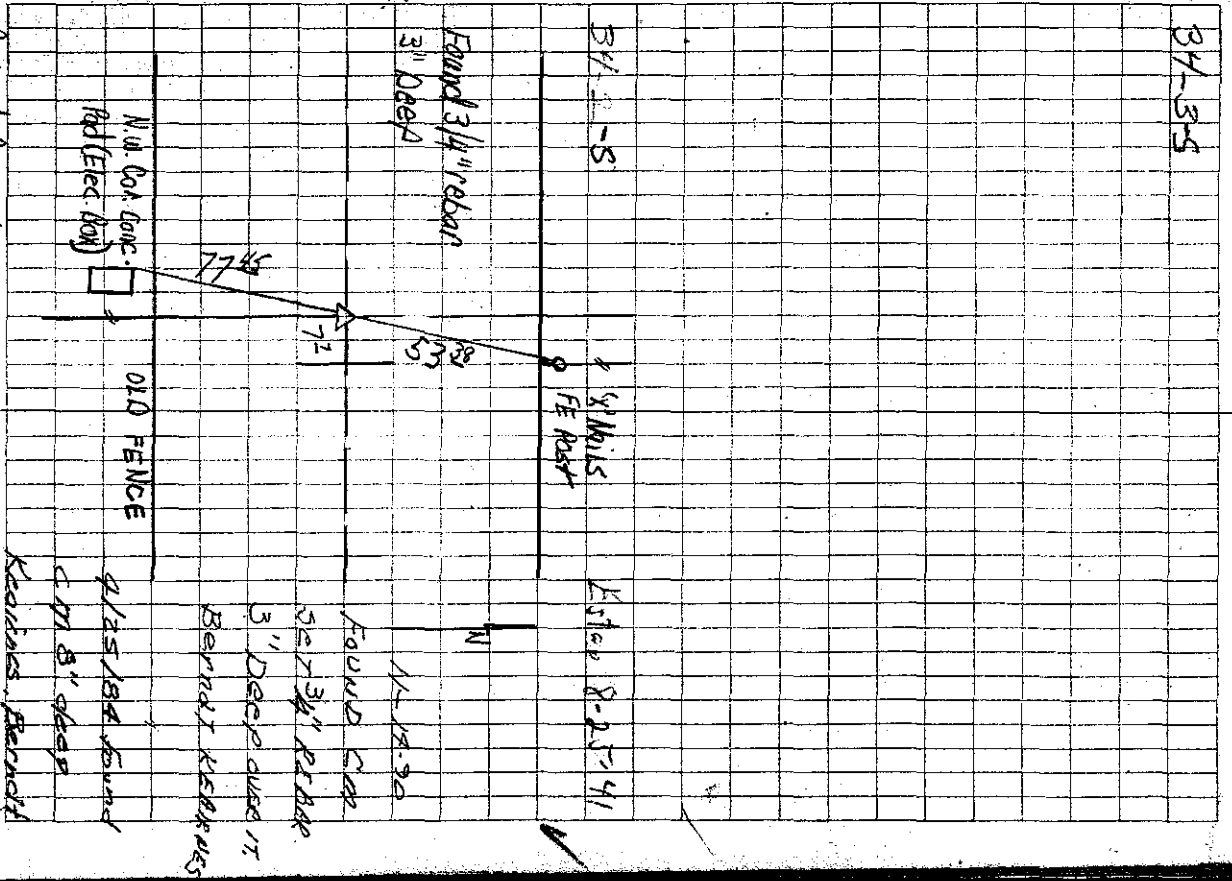

Found 5-29-86  
MOSLER, AMBER, SANDY  
Kearnes, Berndt

Found 3 1/4" rebar  
3" Deep  
1-18-90  
Found car  
Set 3 1/4" rebar  
3" Deep used in  
Berndt Kearnes

34-3-5  
8" Mills  
FE Post  
Est. 8-25-41