

Crawford County Recorder
 Denise Meeves
Fee Book 2013-0588
 03/15/2013 @10:05AM
 PLC: PLAT CORNER CER
 Book: Page: # Pages: 1
 Total Fees: \$7.00

PREPARED BY & RETURN TO MIKE SCHULTE, SNYDER & ASSOCIATES, INC. 1751 MADISON AVE, COUNCIL BLUFFS, IOWA 51503 (712) 322-3202

UNITED STATES PUBLIC LAND SURVEY CORNER CERTIFICATE OF

Land Survey Monuments situated in Section 15, Township 83, Range 37, of the Fifth Principal Meridian, CRAWFORD, County, Iowa. Previously recorded in 2006-2402 in County Recorder's Office.
 (book, page, document number, ect.)

(Show reason for preparing this certificate, the evidence and detailed procedures used in establishing the corner positions and monumentation found or placed.)

Monument Description and Remarks:

FOUND CONCRETE MONUMENT 3" DEEP USING TIES RECORDED IN FEE BOOK 2006-2402. TOP HAS BEEN BROKEN. SET CONCRETE NAIL WITH YPC #17979 IN TOP CENTER TO BETTER DEFINE MEASUREMENT POINT. ONE OF THE TIES NORTH IS NOW MISSING. RETIED CORNER.

Plan-View

(Show a minimum of three reference ties to durable physical objects, relevant monuments and physical conditions that will enable recovery of the corner.)

WGS84 - IA RTN DERIVED
 NAD83(2011)(EPOCH 2010.00)
 42°00'32.34762"N
 95°08'24.98467"W

N1/4 CORNER
 FOUND CONCRETE MONUMENT

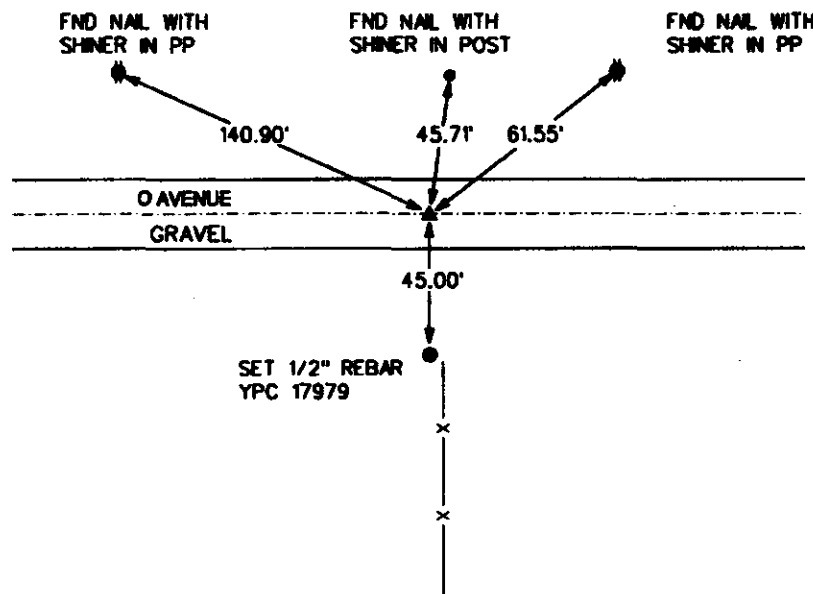
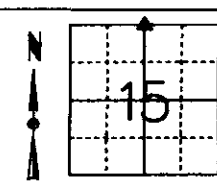

I hereby certify that this land surveying document was prepared and the related surveying work was performed by me or under my direct supervision and that I am a duly licensed Land Surveyor under the laws of the State of Iowa.
 Mike Schulte, PLS Date: 3/15/13
 License Number: 17979
 My License Expires Date: 12/31/2013
 Pages or sheets covered by this map: SHEET 1 OF 1

List Corners to be Indexed

| Corners | Section | Twp | Range |
|----------|---------|-----|-------|
| N1/4 COR | 15 | 83 | 37 |
| S1/4 COR | 10 | 83 | 37 |