

INDEXED DM  
 FOLLOW UP DM  
 PROOFED DM  
 SCANNED DM

REC009584



Crawford County Recorder Denise Meeves  
 FEE BOOK 2006-0559 3/06/2006 @ 09:49AM  
 PLC PLAT CORNER CERBook: Page: #: 1  
 Total Fees: \$.00

PREPARED BY: MICKAEL BERNDT  
 CRAWFORD COUNTY ENGINEERS OFFICE - COURTHOUSE - DENISON, IA. - 712-263-2449

**UNITED STATES PUBLIC LAND SURVEY CORNER CERTIFICATE  
 OF**

LAND SURVEY MONUMENT SITUATED IN HANOVER TOWNSHIP, THE WEST 1/4  
 CORNER OF SECTION 33, T-84N, R-40W OF THE 5TH P.M. CRAWFORD COUNTY, IOWA.

PREVIOUSLY RECORDED AS NO. 97-2493

**MONUMENT DESCRIPTION AND REMARKS**

WEST 1/4 CORNER SEC. 33-84-40

IN 2005 AN HMA OVERLAY WAS PLACED ON M14. THE CORNERS WERE TIED OFF AND RESET AFTER THE OVERLAY PROJECT WAS COMPLETED. A 3" X 3/8" ROUND HEADED BOLT WAS DRIVEN IN THE ASPHALT AND RECESSED 1/4" BELOW THE SURFACE. SET 10-11-05

WEST 1/4 CORNER SEC. 33-84-40

ALL DISTANCES ARE SLOPED CHAINED

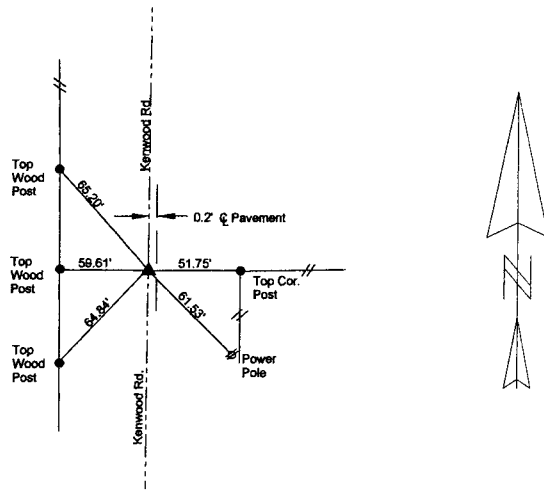

CORNER: WEST 1/4  
 SECTION: 33  
 TOWNSHIP: 84N  
 RANGE: 40W

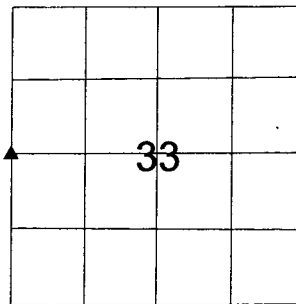

**CERTIFICATION:**

I HEREBY CERTIFY THAT THIS LAND SURVEYING DOCUMENT WAS PREPARED AND THE RELATED SURVEY WORK WAS PERFORMED BY ME OR UNDER MY DIRECT PERSONAL SUPERVISION AND THAT I AM A DULY LICENSED LAND SURVEYOR UNDER THE LAWS OF THE STATE OF IOWA.

Mickael F. Berndt 3-6-06  
 Signature Date of Survey  
 Mickael F. Berndt 14808 Dec. 31, 2006  
 Typed Name L.S. No. License Renewal Date

Pages covered by this seal: 1

