

29-28 Dug 32x5x18' Date 11-2-39

E 1/2 cor of sec-29-84-40

Stone gone

Reset corner on true line

between Sec corners and at

midpoint

line to East

distance from center of section

25 through the 40 corner checks

straight line.

Set C.M. stamped 29+28

12" deep

Ties from 1887 to cor posts

30.7 W. from cor post

29.1 E. " " N. gate post

35.1 N.E. " " S. gate post

26.8 E. " " fence line

843 WEST B
18-8-5

TIES FROM
GRADING
PLAN # 57-9

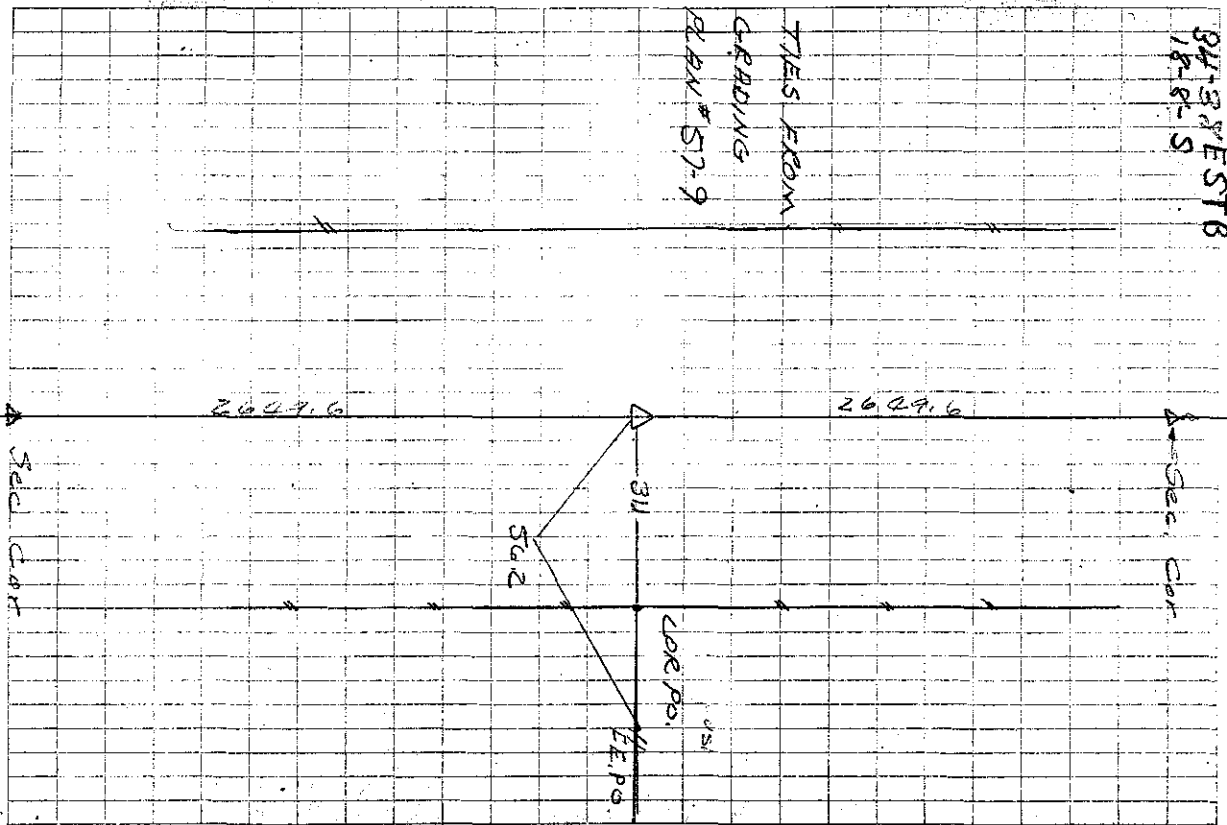

L. 11-2-39 2-5-40 ✓3