

INDEXED DM
 FOLLOW UP _____
 RECORDED _____
 SURVEYED _____

Instrument #: 2015-2379
 11/16/2015 11:19:05 AM Total Pages: 1
 PLC PLAT CORNER CER
 Recording Fee: \$0.00 Transfer Tax: \$0
 Denise Meeves, Recorder, Crawford County Iowa



PREPARED BY: PAUL ASSMAN-CRAWFORD COUNTY ENGINEER'S OFFICE-COURTHOUSE-DENISON, IA.-712-263-2449

UNITED STATES PUBLIC LAND SURVEY CORNER CERTIFICATE OF

LAND SURVEY MONUMENT SITUATED IN HANOVER TOWNSHIP, THE NORTH 1/4 CORNER OF SECTION 17, T-84N,
R-40W OF THE FIFTH P.M. CRAWFORD COUNTY, IOWA.

PREVIOUSLY RECORDED AS NO. 2003-1932

MONUMENT DESCRIPTION AND REMARKS

NORTH 1/4 CORNER SEC. 17-84-40

FOUND CONCRETE MONUMENT. COUNTY GRADED ROAD.
 AFTER GRADING WAS COMPLETED, SET 5/8" REBAR WITH
 RED CAP #11982 0.7' DEEP AND RETIED CORNER.

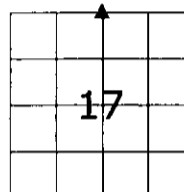

NORTH 1/4 CORNER SEC. 17-84-40

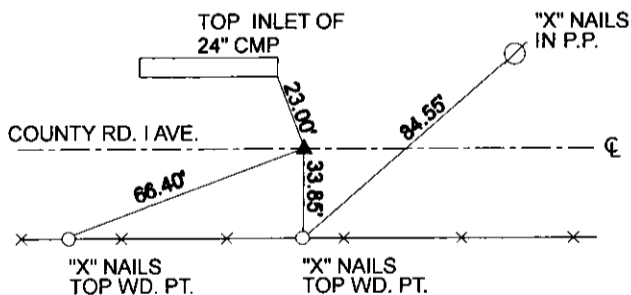

ALL DISTANCES ARE PLUMB CHAINED

CERTIFICATION:

I HEREBY CERTIFY THAT THIS LAND SURVEYING DOCUMENT WAS PREPARED AND THE RELATED SURVEY WORK WAS PERFORMED BY ME OR UNDER MY DIRECT PERSONAL SUPERVISION AND THAT I AM A DULY LICENSED LAND SURVEYOR UNDER THE LAWS OF THE STATE OF IOWA.

Paul J. Assman
 Signature

11/3/15
 Date of Survey

PAUL J. ASSMAN
 Typed Name

11982
 L.S. No.

12-31-16
 License Renewal Date

Pages covered by this seal 1

