

12/7 Estb. cor from H.L. Fishels ties
of C. Bk. 10-P. 68. Dug 6x10x10 hole. No
find. George Staley thinks cor. is gone
Used above reference for Est. bmt.

Set C.M. 10' below bottom of ditch.

Ties as per Fishels Bk 10-P. 68.

W. from range of N. side house 39.8 + N. 37.1 to C.M.

W. " " " " N. " barn, 25.5 + N. 73.3 to C.M.

Used transit on lines North to C.M.

63.3 E from cor. post.

38.0 SW. from cor. post.

56.7 NW. " " NW. cor. house.

N Cor 12

Dug 4x6x9 hole in line
to south corner of old
house. Discovered
stone. Well dug. We established
corner, by running transit
line from NW cor. to NE cor.
at 12-84-39. Then transit
line N. 20' set at intersection
of the lines. This was necessary
with the Sec. Cor.

ties from x-spks

25.1 North of tel. pole

34.9 SW of 6" maple (etc.)

Ties OK 3/12/91

Dug-8-15-40
Set 3-24-92
Champion

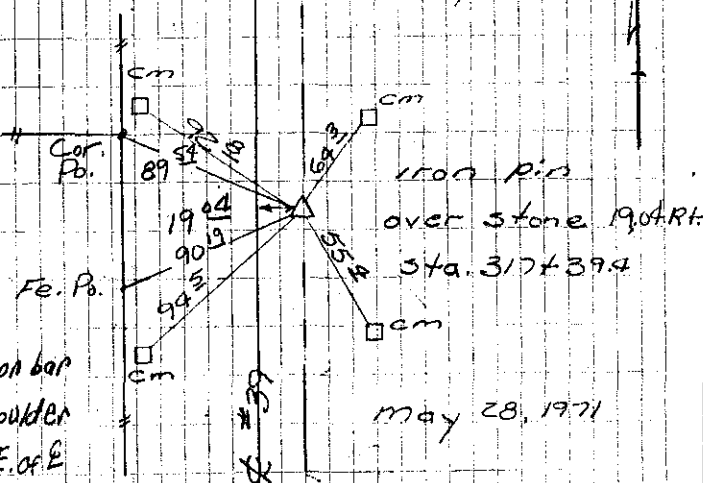

3-9-94 5/8" iron bar

4" deep in shoulder

of Hwy. 19th E. of E

Relied from Sec. Cor. Cert.

Established Set 6-9-92

Chief - Champion

Found 11/29/62 N 20' Cor

Pul Iron Rod to Surface

Carrying stakes

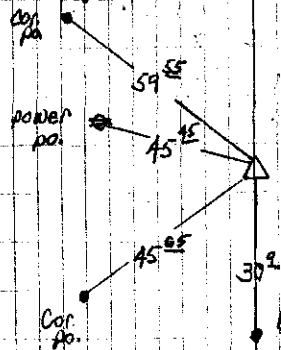

Cor is 20' East of Range of fence south

1x5/8" iron bar over
1" bot 2" deep
Relied from Sec. Cor. Cert.
3-9-94