

INDEXED _____
 FOLLOW UP _____
 PROOFED _____
 SCANNED _____

Instrument #: 2018-1918
 09/18/2018 01:51:26 PM Total Pages: 1
 PLC PLAT CORNER CER
 Recording Fee: \$0.00 Transfer Tax: \$0
 Denise Meeves, Recorder, Crawford County Iowa



PREPARED BY: PAUL ASSMAN-CRAWFORD COUNTY ENGINEER'S OFFICE-COURTHOUSE-DENISON, IA.-712-263-2449

UNITED STATES PUBLIC LAND SURVEY CORNER CERTIFICATE OF

LAND SURVEY MONUMENT SITUATED IN GOODRICH TOWNSHIP, THE SOUTHEAST CORNER OF SECTION 2,
T-84N, R-39W OF THE FIFTH P.M. CRAWFORD COUNTY, IOWA.

PREVIOUSLY RECORDED AS NO. 2002-1152

MONUMENT DESCRIPTION AND REMARKS

SOUTHEAST CORNER SEC. 2-84-39

FOUND 5/8" IRON PIN 0.3' DEEP IN ACCORDANCE WITH PREVIOUS TIES. COUNTY GRADED ROAD, PROJECT NO. LG49-12N.SET 5/8" X 18" REBAR WITH RED CAP #11982 0.8' DEEP OVER MONUMENT AND RETIED CORNER.

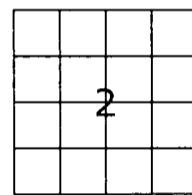

SOUTHEAST CORNER SEC. 2-84-39

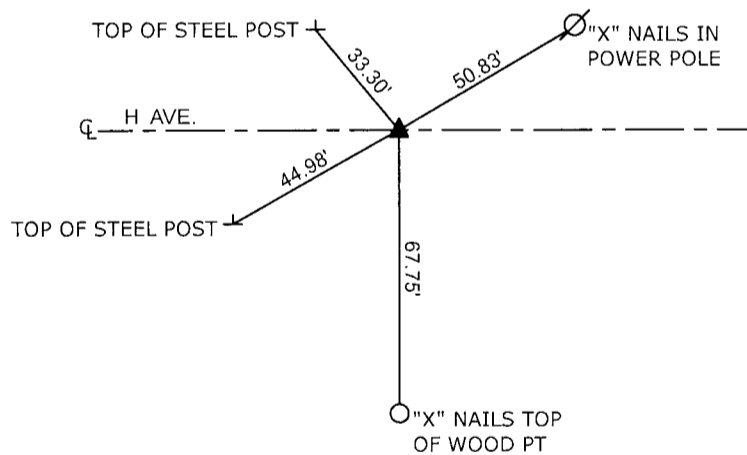

ALL DISTANCES ARE SLOPE CHAINED

CERTIFICATION:

I HEREBY CERTIFY THAT THIS LAND SURVEYING DOCUMENT WAS PREPARED AND THE RELATED SURVEY WORK WAS PERFORMED BY ME OR UNDER MY DIRECT PERSONAL SUPERVISION AND THAT I AM A DULY LICENSED LAND SURVEYOR UNDER THE LAWS OF THE STATE OF IOWA.

	7/31/18
Signature	Date of Survey
PAUL J. ASSMAN	12-31-18
Typed Name	License Renewal Date
11982	L.S. No.

