

Crawford County Recorder  
 Denise Neeves  
**Fee Book 2012-1214**  
 05/31/2012 802:06PM  
 PLC PLAT CORNER CER  
 Book: Page: # Pages: 1  
 Total Fees: \$0.00

RECORDED  
 INDEXED  
 FILED  
 SERIALIZED

PREPARED BY: PAUL ASSMAN-CRAWFORD COUNTY ENGINEER'S OFFICE-COURTHOUSE-DENISON, IA-712-263-2449

**UNITED STATES PUBLIC LAND SURVEY CORNER CERTIFICATE  
 OF  
 LAND SURVEY MONUMENT SITUATED IN GOODRICH TOWNSHIP, THE CENTER OF SECTION 11, T-84N, R-39W OF  
 THE FIFTH P.M. CRAWFORD COUNTY, IOWA.**

PREVIOUSLY RECORDED AS NO. 2003-3095

**MONUMENT DESCRIPTION AND REMARKS**

CENTER OF SEC. 11-84-39

FOUND 5/8" DIA. X 18" REBAR  
 COUNTY GRADED ROAD AND RESET 5/8" X 18" REBAR W/  
 RED CAP # 11982 0.5' DEEP

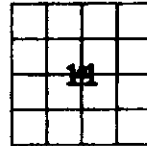

CENTER OF SEC. 11-84-39

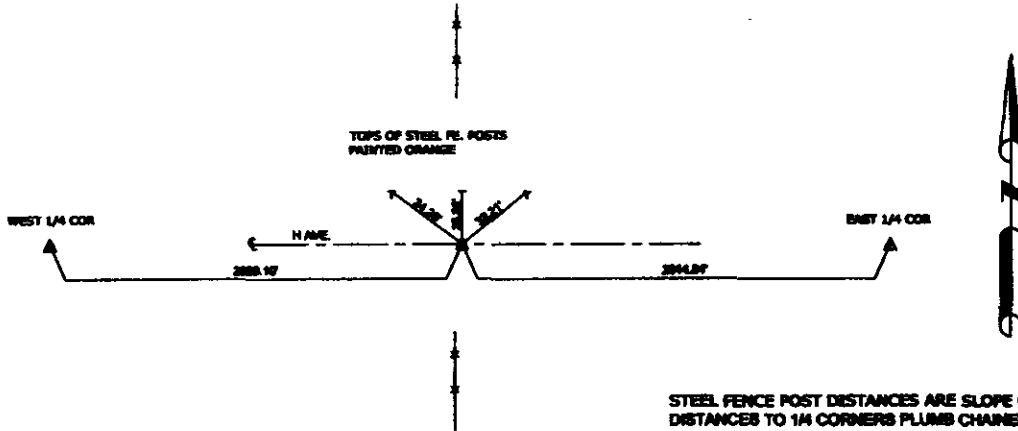

STEEL FENCE POST DISTANCES ARE SLOPE CHAINED  
 DISTANCES TO 1/4 CORNERS PLUMB CHAINED

<p><b>CERTIFICATION:</b>          I HEREBY CERTIFY THAT THIS LAND SURVEYING DOCUMENT WAS PREPARED AND THE RELATED SURVEY WORK WAS PERFORMED BY ME OR UNDER MY DIRECT PERSONAL SUPERVISION AND THAT I AM A DULY LICENSED LAND SURVEYOR UNDER THE LAWS OF THE STATE OF IOWA.</p>			
<p><i>Paul J. Assman</i>          Signature</p>		<p>5/16/2012          Date of Survey</p>	
<p>PAUL J. ASSMAN          Typed Name</p>	<p>11982          L.S. No.</p>	<p>12-31-12          License Renewal Date</p>	
<p>Pages covered by this cert. <u>1</u></p>			