

Denise Meeves RECORDER
 Crawford County, Iowa
 Instr. Number: 2019-0605
 Recorded: 4/8/2019 at 9:44:46.0 AM
 Pages 1
 County Recording Fee: \$7.00
 Iowa E-Filing Fee: \$3.13
 Combined Fee: \$10.13
 Revenue Tax:

PREPARED BY AND RETURN TO: MIKE SCHULTE, SCHULTE SURVEYING, INC., 2003 390TH STREET, WESTSIDE, IA 51467 (712) 790-3489

UNITED STATES PUBLIC LAND SURVEY CORNER CERTIFICATE OF
 LAND SURVEY MONUMENTS SITUATED IN SECTION 31, TOWNSHIP 83 NORTH, RANGE 37 WEST, OF THE FIFTH
 PRINCIPAL MERIDIAN, CRAWFORD COUNTY, IOWA. PREVIOUSLY RECORDED IN 2000-0226 IN COUNTY
 RECORDER'S OFFICE. (book, page/instrument number)

NW CORNER
 FND 5/8" YPC 8893 12" DEEP
 NORTHING 7225690.92 EASTING 16642749.85

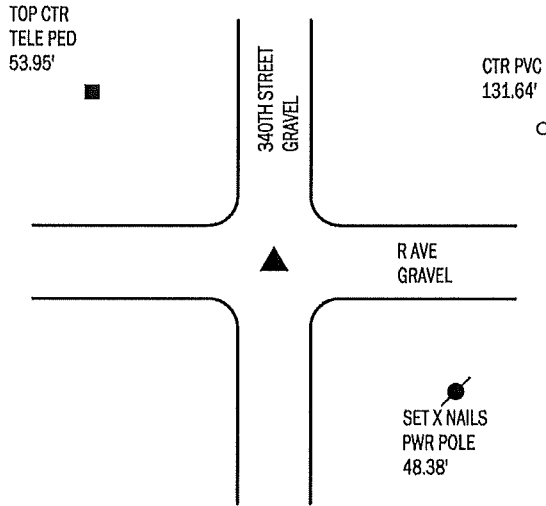
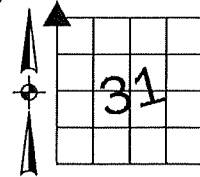

USED TIES RECORDED INST 2000-0226 TO FIND A 5/8" MONUMENT WITH YELLOW PIN CAP 8893 12" DEEP. SOME OF THE PREVIOUS TIES ARE NOW MISSING, SO ADDITIONAL REFERENCES WERE SET AND CORNER RETIED.

*All distances are measured horizontally unless noted.

LIST CORNERS TO BE INDEXED

CORNER	SECTION	TWP	RANGE
NW COR	31	83	37
SW COR	30	83	37
NE COR	36	83	38
SE COR	25	83	38

I HEREBY CERTIFY THAT THIS LAND SURVEYING DOCUMENT WAS PREPARED BY ME OR UNDER MY DIRECT PERSONAL SUPERVISION AND THAT I AM A DULY LICENSED PROFESSIONAL LAND SURVEYOR UNDER THE LAWS OF THE STATE OF IOWA.

Mike Schulte
 MIKE SCHULTE 2019/04/04
 DATE
 LICENSE NUMBER: 17979
 LICENSE RENEWAL DATE IS DECEMBER 31, 2019
 PAGES COVERED BY THIS SEAL: 1 OF 1

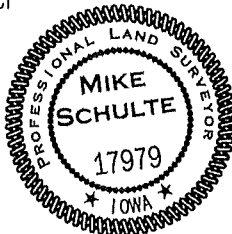

BASIS OF BEARING
 IaRCS ZONE 6 - US SURVEY FEET
 IaRTN DERIVED - NAD83(2011)(EPOCH 2010.00)

SCHULTE SURVEYING, INC.

DRAWN BY: MLS
 PROJ NUMBER: 19-017