

FILED DENISON, IOWA
CRAWFORD COUNTY

INDEXED
CORRECTED
CROTTED

2000 NO 17 AM 11:47

INST. NO. 2000-2906

DENISE MEEVES, RECORDER
Denise Meeves

FFC #600
Mary Eiten, Deputy

PREPARED BY J. SCOTT SHEVEL L.S., KUEHL AND PAYER LTD., P.O. BOX 458 1725 N. LAKE AVE. STORM LAKE, IOWA 50588 TELEPHONE (712)732-6292

UNITED STATES PUBLIC LAND SURVEY CORNER CERTIFICATE OF

LAND SURVEY MONUMENTS SITUATED IN SECTION 30, TOWNSHIP 83 NORTH,
RANGE 38 WEST, OF THE 5TH PRINCIPAL MERIDIAN, CRAWFORD COUNTY, IOWA.

PREVIOUSLY RECORDED IN BOOK _____ PAGE _____

MONUMENT DESCRIPTION AND REMARKS:

1.) E 1/4 CORNER 30-83-38: FOUND CONCRETE MONUMENT 1" DEEP

PLAN - VIEW

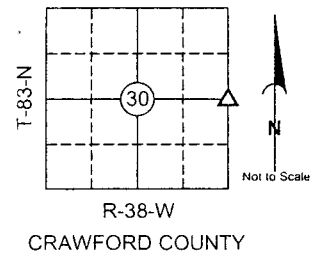
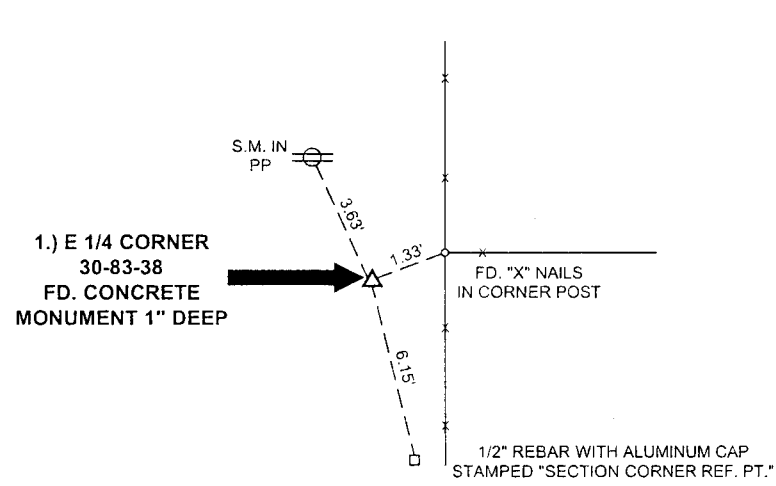

S.M. = SURVEY MARKER
PLASTIC REFERENCE DISK
AS SHOWN BELOW

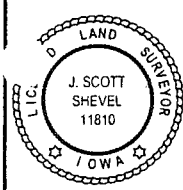

I hereby certify that this land surveying document was prepared and the related survey work was performed by me or under my direct personal supervision and that I am a duly licensed Land Surveyor under the laws of the State of Iowa.

J. Scott Shevel 10/26/00
Date: _____
J. Scott Shevel
License Number 11810
My license renewal date is December 31, 2001
Pages covered by this seal 1

List Corners to be Indexed

Corners	Section	Township	Range
1) E 1/4	30	83	38

PN: 000176
DRAWN: JMK