

INDEXED             
FOLLOW UP             
PROCESSED             
SCANNED           

11/05/2007 @10:54AM  
PLC PLAT CORNER CER # Pages: 1  
Book: Page: \$7.00  
Total Fees:

PREPARED BY - TERENCE E. CRAWFORD - SUNDQUIST ENGINEERING - 120 S. MAIN, DENISON, IOWA 51442 - PHONE (712) 263-8118

## UNITED STATES PUBLIC LAND SURVEY CORNER CERTIFICATE OF

LAND SURVEY MONUMENT SITUATED IN SECTION 29, T 83 N, R 38 W OF  
THE 5TH P.M., CRAWFORD COUNTY, IOWA.  
PREVIOUSLY RECORDED IN BOOK           , PAGE           , OTHER           

### MONUMENT DESCRIPTION AND REMARKS

N1/4 CORNER - FOUND CM FLUSH, SET 5/8" DIA. X 18" IRON PIN  
ON SOUTH SIDE OF CM 0.3' DEEP.

CENTER - SET 5/8" DIA. X 18" IRON PIN W/YELLOW CAP #8893  
0.15' ABOVE GROUND, SET AT INTERSECTION OF N-S  
FENCE LINE AND FENCE LINE WEST.

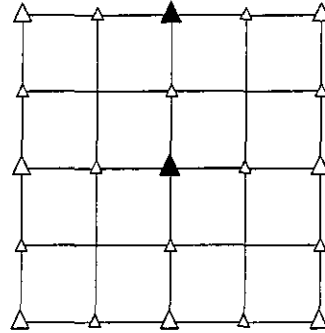

### PLAN VIEW SHOWING RELATIVE LOCATION OF MONUMENT AND REFERENCE POINTS.

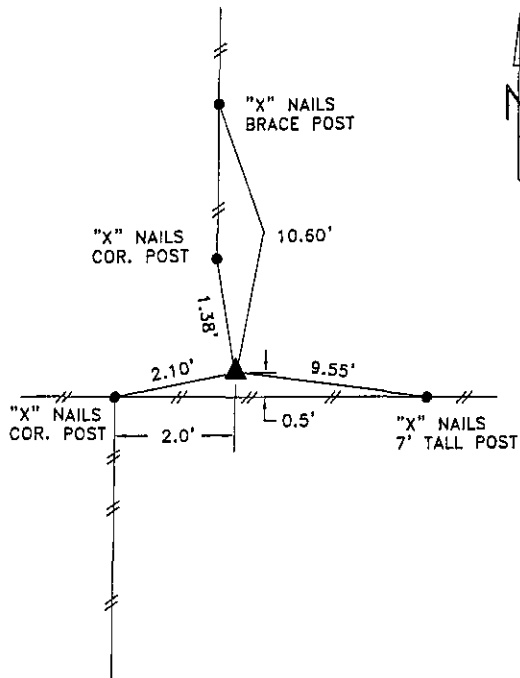

DISTANCES PLUMB CHAINED

N1/4 CORNER SECTION 29-83-38

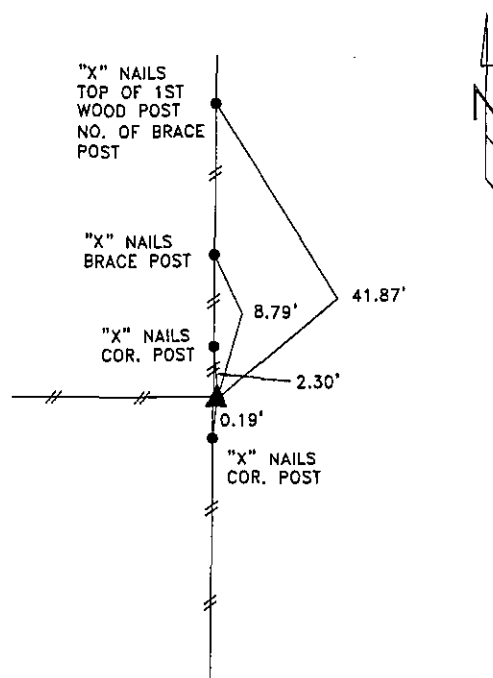

DISTANCES PLUMB CHAINED

CENTER OF SECTION 29-83-38

I HEREBY CERTIFY THAT THIS LAND SURVEYING DOCUMENT WAS PREPARED  
AND THE RELATED SURVEY WORK WAS PERFORMED BY ME OR UNDER MY  
DIRECT PERSONAL SUPERVISION AND THAT I AM A DULY LICENSED LAND  
SURVEYOR UNDER THE LAWS OF THE STATE OF IOWA.

Terence E. Crawford NOV 01 2007  
TERENCE E. CRAWFORD DATE  
IA LICENSE NO. 8893 EXP. DATE DECEMBER 31, 2007

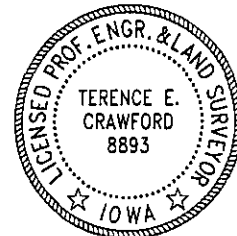

SE PROJECT NO. 25507  
DRAWN BY: LLL