

18-17 Found 2 limestone $3 \times 6 \times 8$ "
at a depth of $2\frac{1}{2}$ ' Lowered and
Set C-M

ties

35.2 W. from cor post

84.7 NNW " " tel. pole

34.4 E " " cor post

55.9 NE " " REA pole

7

18 Large cotton wood tree

in corner did not dig

Established by Iowa Reg.

#4129 on 11-8-90 set iron pin
w/cap

Ties from "X" nails in posts "slope chained"

12.88 S. from Brace Post

22.15 S.E. from Gate Post N.W.

1.88 S.W. from Cor. Po.

6.88 N.W. from Brace Post

37 ✓

Found G. m. Flash

30-37-F

Found G. m. Flash

Top Broken off

3-10-81 25°

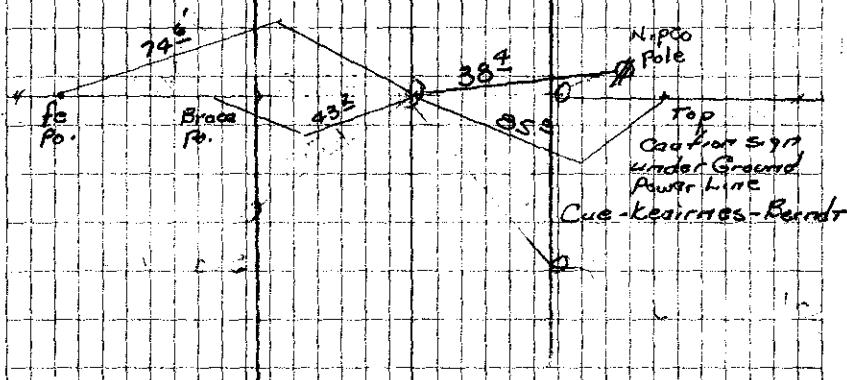

30-38-5

DUG-6-18-40

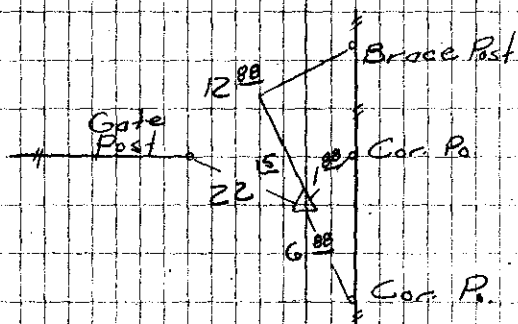

W.S.