

INDEXED DM/DM
 FOLLOW UP 30
 PROOFED 30
 SCANNED DM

Crawford County Recorder
 Denise Meeves
Fee Book 2013-2027
 08/22/2013 @11:50AM
 PLC PLAT CORNER CER
 Book: Page: # Pages: 1
 Total Fees: \$0.00

PREPARED BY: PAUL ASSMAN-CRAWFORD COUNTY ENGINEER'S OFFICE-COURTHOUSE-DENISON, IA.-712-263-2449

UNITED STATES PUBLIC LAND SURVEY CORNER CERTIFICATE OF

LAND SURVEY MONUMENT SITUATED IN DENISON TOWNSHIP, THE EAST 1/4 CORNER OF SECTION 36, T-83N,
R-39W OF THE FIFTH P.M. CRAWFORD COUNTY, IOWA.

PREVIOUSLY RECORDED AS NO.

MONUMENT DESCRIPTION AND REMARKS

EAST 1/4 CORNER SEC. 36-83-39

FOUND BROKEN OFF CONC. MONUMENT AT SURFACE.
 LOWERED 3.0' DEEP AND SET 5/8" X 18" REBAR WITH RED
 CAP #11982 1.5' DEEP OVER MONUMENT & RE-TIED
 CORNER.

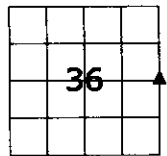

EAST 1/4 CORNER SEC. 36-83-39

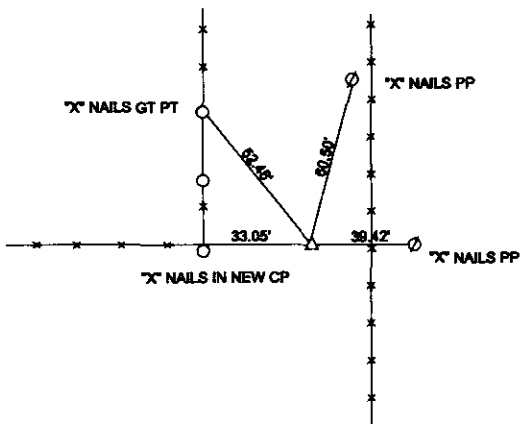

ALL DISTANCES ARE SLOPE CHAINED

CERTIFICATION:
 I HEREBY CERTIFY THAT THIS LAND SURVEYING DOCUMENT WAS PREPARED AND THE RELATED SURVEY
 WORK WAS PERFORMED BY ME OR UNDER MY DIRECT PERSONAL SUPERVISION AND THAT I AM A DULY
 LICENSED LAND SURVEYOR UNDER THE LAWS OF THE STATE OF IOWA.

Signature: *Paul J. Assman* Date of Survey: 7/17/13

PAUL J. ASSMAN 11982 12-31-14
 Typed Name L.S. No. License Renewal Date

Pages covered by this seal 1

