

PREPARED BY - TERENCE E. CRAWFORD - SUNDQUIST ENGINEERING - 120 S. MAIN, DENISON, IOWA 51442 - PHONE (712)263-8118

UNITED STATES PUBLIC LAND SURVEY CORNER CERTIFICATE OF

LAND SURVEY MONUMENT SITUATED IN SECTION 10, T 83 N, R 39 W OF
THE 5TH P.M., CRAWFORD COUNTY, IOWA.
PREVIOUSLY RECORDED IN BOOK _____, PAGE _____, OTHER INST. NO. 93-0713

MONUMENT DESCRIPTION AND REMARKS

SE CORNER - FOUND 5/8" DIA. GAS PIPE W/I.D.O.T. ALUMINUM DISK

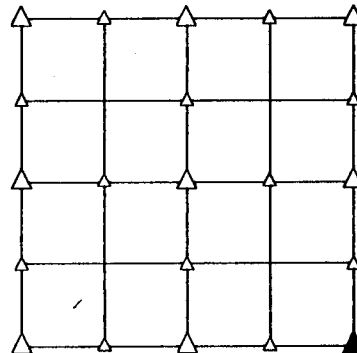

PLAN VIEW SHOWING RELATIVE LOCATION OF MONUMENT AND REFERENCE POINTS.

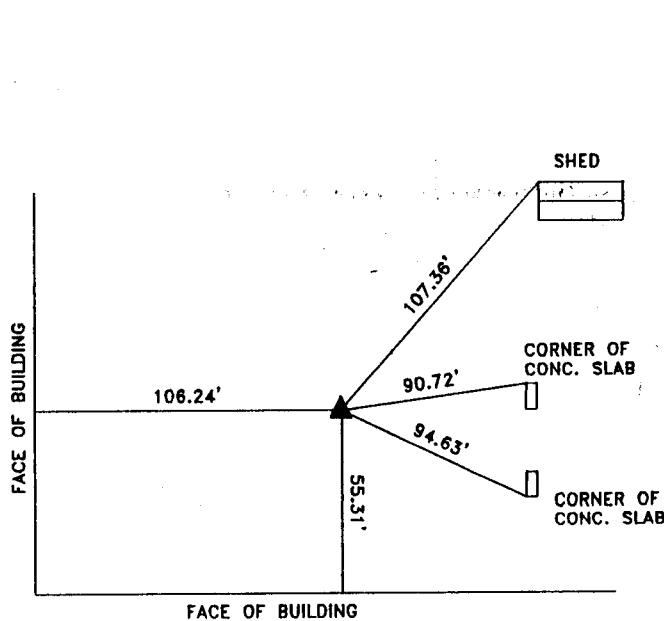

OLD DUBUQUE PLANT

DISTANCES SLOPE CHAINED

SE CORNER SECTION 10-83-39

I HEREBY CERTIFY THAT THIS LAND SURVEYING DOCUMENT WAS PREPARED
AND THE RELATED SURVEY WORK WAS PERFORMED BY ME OR UNDER
MY DIRECT SUPERVISION AND THAT I AM A DULY LICENSED LAND
SURVEYOR UNDER THE LAWS OF THE STATE OF IOWA.

Terence E. Crawford
TERENCE E. CRAWFORD

IA LICENSE NO. 8893

MAY 23 2000

DATE

EXP. DATE DECEMBER 31, 2001

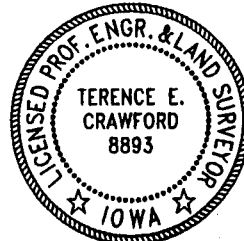

SE PROJECT NO. 03400