

SW. Cor NE 1/4, SW 1/4 Sec 15
 Ties from Ia. Reg. # 4129 Set 5/8" iron Pin
 10/16/90
 "Nails in poles"

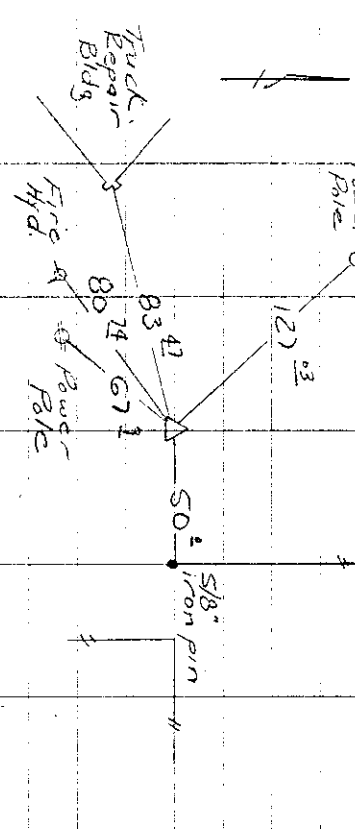

SE Cor NE 1/4, SW 1/4 Sec. 15
 10/16/90 Ties from Ia. Reg. # 4129

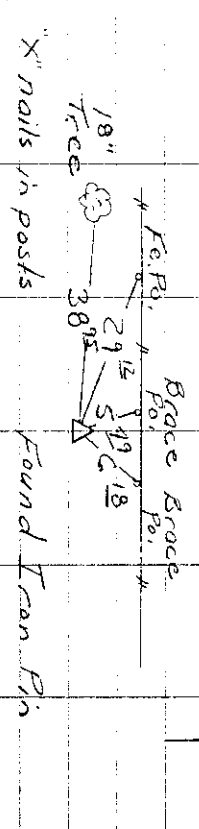

NW. Cor NE 1/4, NE 1/4 Sec. 10
 Set capped Iron Pin
 Sundquist Crew.
 RCS # 4129

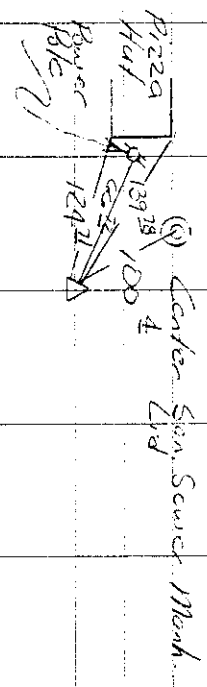

SE. Cor. SW 1/4 SE 1/4 SEC. 10-83-39 1978

Found exposed 5/8" rebar
 with steel FE Post

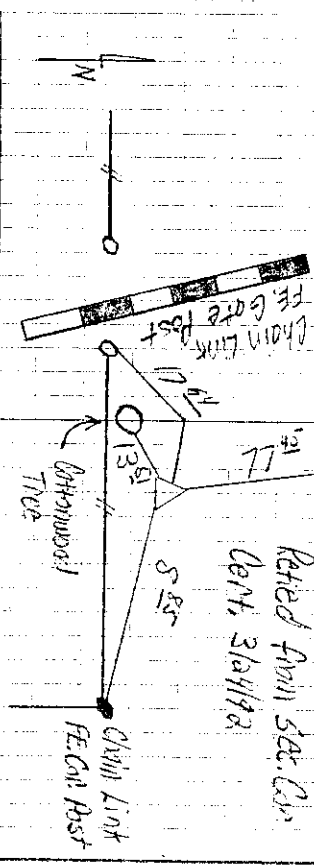

SE. Cor. NE 1/4, NW 1/4 Sec. 12 Retired from sec. Can. Cent. 4/11/93

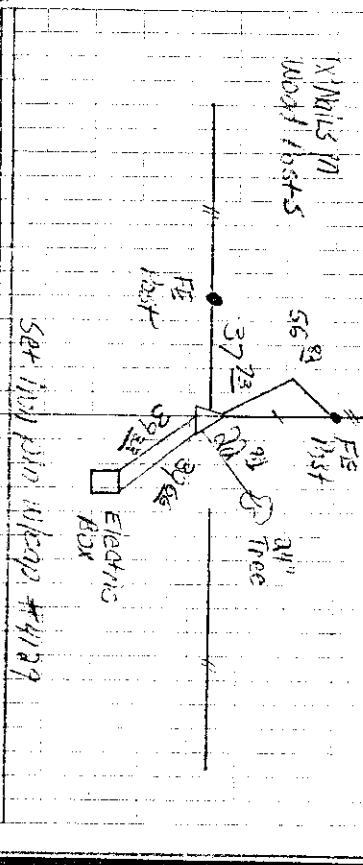

CTR. Sec. 21-83-39

