

# UNITED STATES PUBLIC LAND SURVEY CORNER CERTIFICATE

OF

Land Survey Monuments situated in Section 7, Township 84, Range 41, of the Fifth Principal Meridian, CRAWFORD County, Iowa. Previously recorded in \_\_\_\_\_ in County Recorder's Office.

(book, page, document number, etc.)  
(Show reason for preparing this certificate, the evidence and detailed procedures used in establishing the corner positions and monumentation found or placed.)

Monument Description and Remarks: THIS DOCUMENT IS PREPARED BECAUSE NO PREVIOUS DOCUMENT HAS BEEN RECORDED.

(SEE DESCRIPTION OF MONUMENTS ON SKETCH BELOW)

## PLAN - VIEW

(Show a minimum of three reference ties to durable physical objects, relevant monuments and physical conditions that will enable recovery of the corner.)

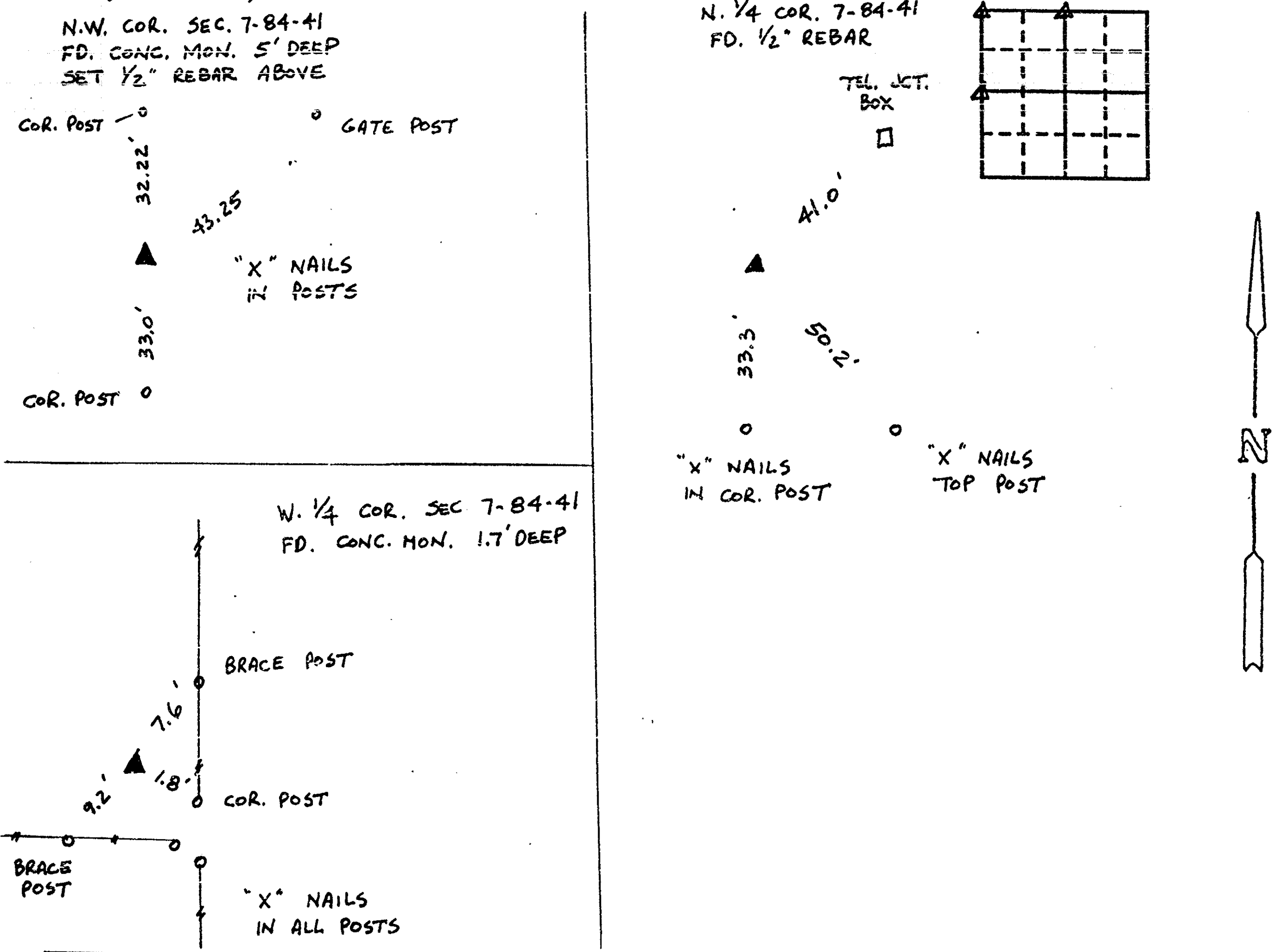

I hereby certify that the survey work was completed and this certificate was prepared by me or under my direct personal supervision and that I am a duly registered land surveyor under the laws of the state of Iowa.

Signature: [Signature]  
Name typed or printed: LELAND V. FAGAN

Date: MAY 22, 1992 Reg. No. 5542

Corners	List Corners to be Indexed		
	Section	Twp	Range
N.W.	7	84	41
N. 1/4	7	84	41
W. 1/4	7	84	41

FILED DENISON, IOWA  
CRAWFORD COUNTY

92 JUN -1 AM 10:11

INST. NO. 92-1339  
DENISE JURGENSEN, RECORDER  
Denise Jurgensen  
FEE \$5.00  
INDEXED [Signature]  
FOLLOW UP \_\_\_\_\_  
PROCEED \_\_\_\_\_

SEAL

