

# MILFORD TWP.

01/10

R-38W

STOCKHOLM TWP.

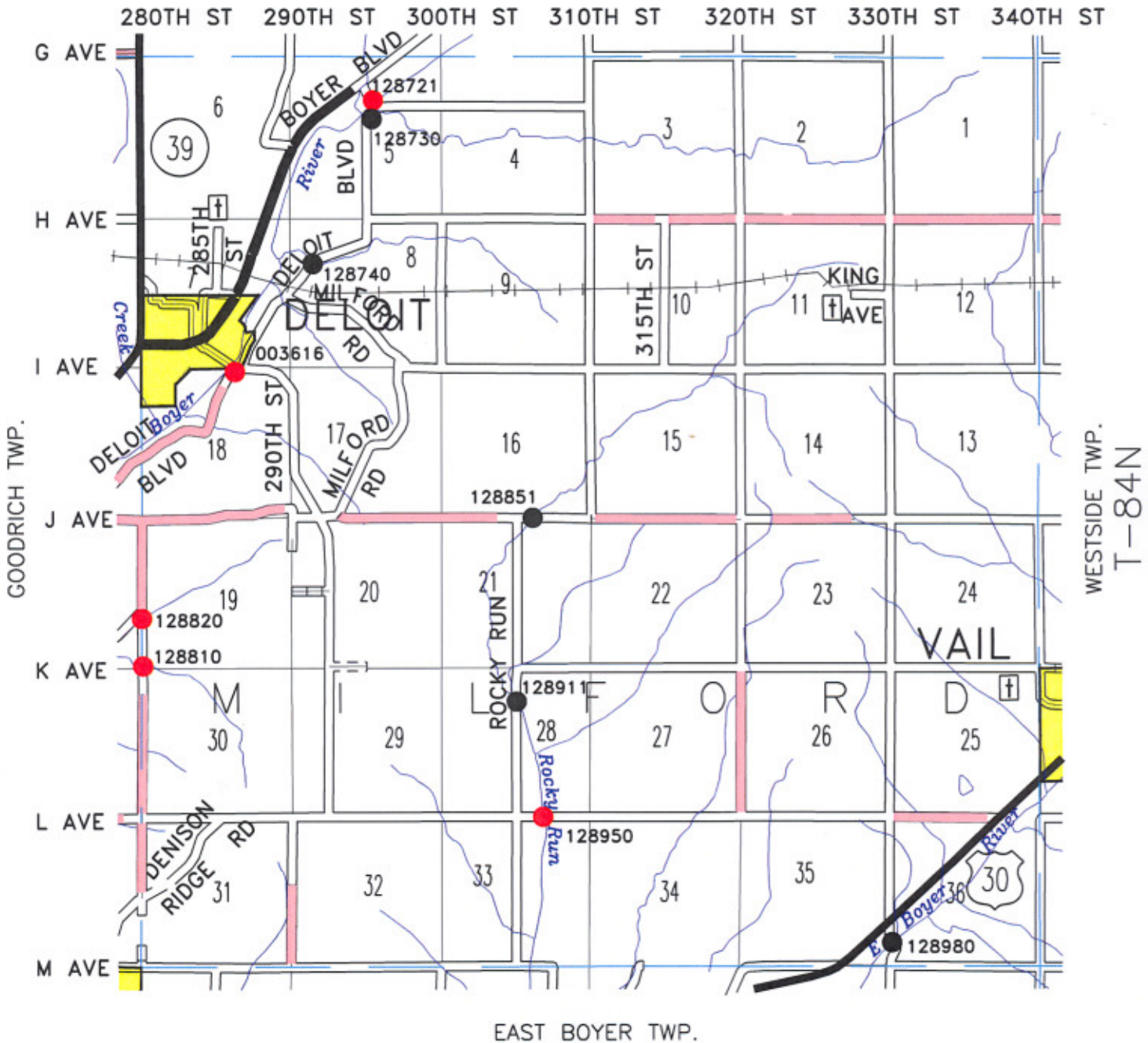

|        |                  |
|--------|------------------|
| 003616 | 24T - 39T - 38T  |
| 128721 | 12T - 18T - 22T  |
| 128730 | LEGAL            |
| 128740 | LEGAL            |
| 128810 | 12T - 17T - 22T  |
| 128820 | 26T - 39T - 40T  |
| 128851 | LEGAL (STR. PLT) |
| 128911 | LEGAL (TWIN RCB) |
| 128950 | 19T - 28T - 37T  |
| 128980 | LEGAL            |

## LEGEND

- LEGAL
- POSTED LOAD LIMITS
- LEVEL B ROADS
- LEVEL C ROADS