

28-27

Found 3 rock 4" x 6" x 8" 6" x 8" x 8"
8" x 8" x 12" brick bats at a depth of
4' Set C.M.

ties

25.9 S.E from 8" burr oak
 25.5 E " " fe. line Post
 33.3 E " " 6" burr oak stump.
 31.0 N.E " " fe Line Post
 38.5 W " " Concrete Cor Post
 dated 1912

21

7

28

Found 4-29-40

25-17 A

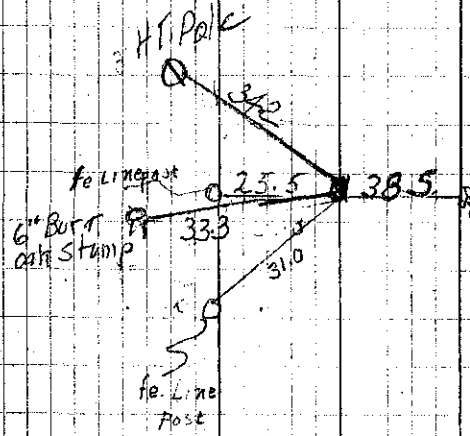

at Mar 21

Tie Taken at Top of Post

Conc cor post dated 1912

E.V.